

NOTE:
 This drawing is copyright of RLM Architects and may not be copied, altered or reproduced in any way without their written authority. All dimensions should be checked on site prior to commencement of affected works. Do not scale from this drawing. If in doubt ask.

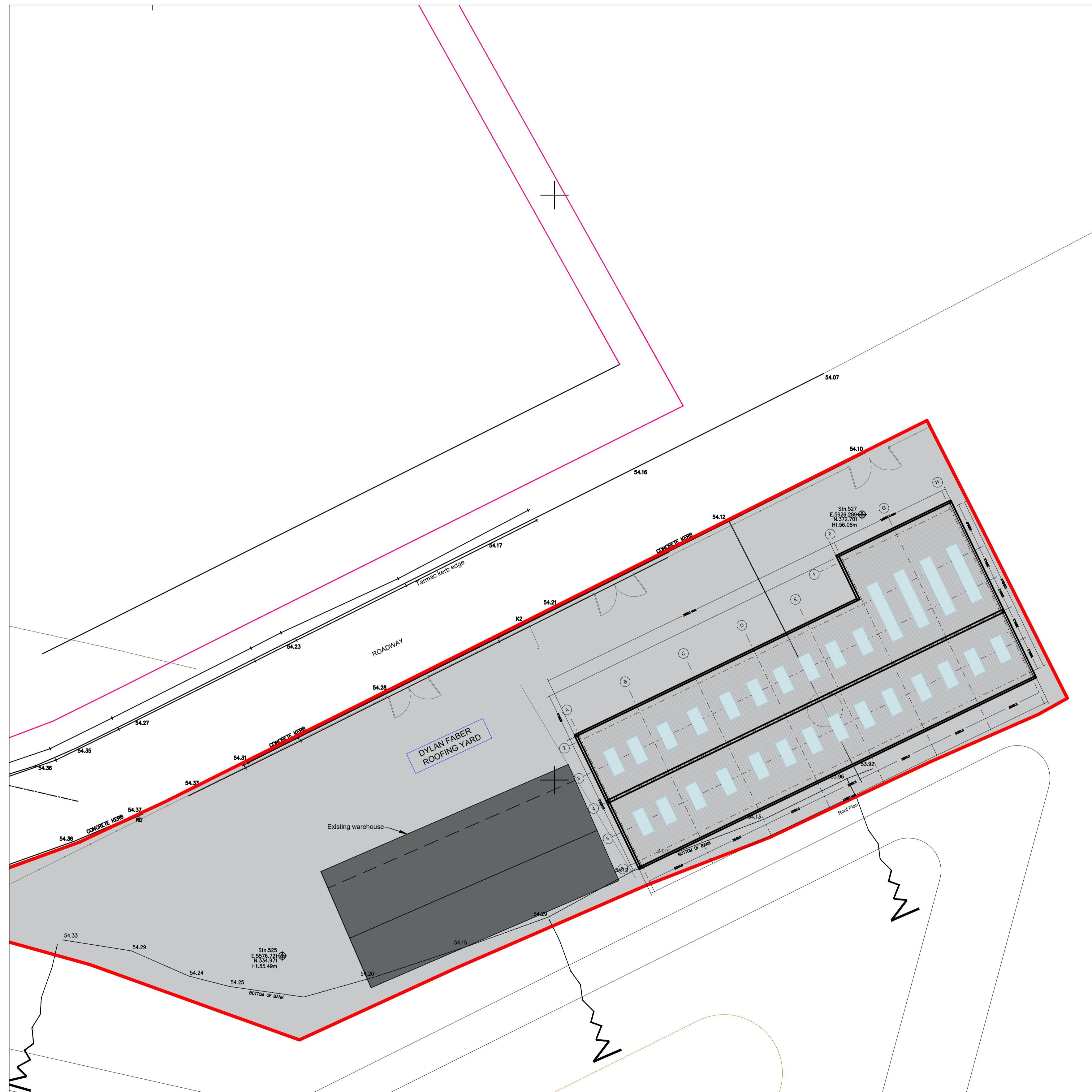

PROPOSED SITE PLAN
 [1:200]

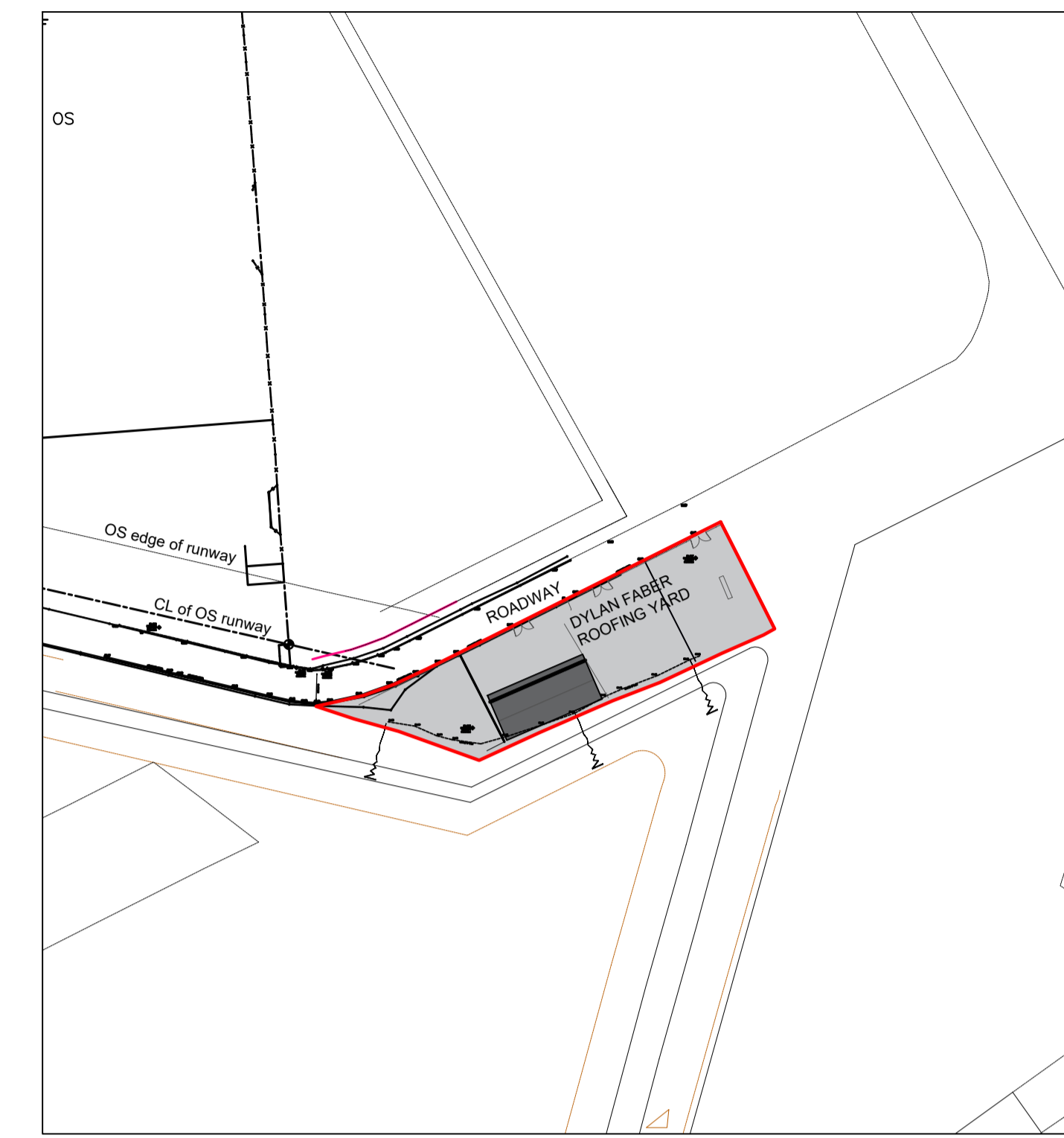
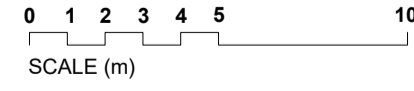

EXISTING LOCATION PLAN
 [1:1250]

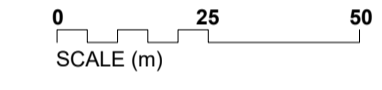

A Issued to Client LAH 29.04.26

PROJECT
 Workshop / storage building
 Dylan Faber Roofing Ltd
 Henstridge Airfield
 The Marsh
 Templecombe
 BA8 0TN

DRAWING TITLE
PROPOSED SITE PLAN - (based on drawings provided by Datum Building for Dylan Faber roofing)

SCALE
 As shown @A1

DATE
 April 2026

DRAWN
 LAH

CHECKED
 KESL

DRAWING NO
2523 - 01

REVISION
A

RLM Architects Chartered Practice
 8 West Street, Wimborne, Dorset, BH21 1JP
 Tel: 01202 393407 Web: www.rlmarchitects.com