

Symonds
& Sampson



2 Thompson Farm Cottage

Manston, Sturminster Newton, Dorset

2 Thompson Farm Cottage

Manston
Sturminster Newton
Dorset DT10 1HD

A semi detached stone cottage, significantly extended with stunning views, large workshop, garden and land in a lovely rural location. In all 1.35 acres.



- Excellent family accommodation of about 2200 sq ft
 - 4/5 bedrooms, 3 bath/shower rooms (2e/s)
 - Sitting room with south facing terrace
 - Secure barn / workshop of just under 1500 sq ft
 - South facing garden, adjoining field. In all 1.35 acres
 - Ample off-road parking
 - Delightful rural location
 - Panoramic countryside views
 - No onward chain

Guide Price **£875,000**

Freehold

Sturminster Sales
01258 473766
sturminster@symondsandsampson.co.uk



THE PROPERTY

2 Thompson Farm Cottages is an original Victorian cottage built in 1880 that has been significantly extended and fully renovated over the last 20 years to now offer extremely spacious and adaptable family accommodation with double glazing throughout. The main aspect is south and west so the principal rooms are light and bright and there are wonderful far-reaching views. The accommodation is set off a large central hall with a super 20' x 18' L-shaped kitchen / dining room with a wood burning stove and a fantastic triple aspect sitting room also with a wood burning stove and French doors opening out to the south facing terrace. There is a ground floor bedroom / reception room, a utility room, original front hall, currently an office and a cloakroom. On the first floor the two principal bedrooms each have ensuite bath / shower rooms with the master bedroom having a Juliet balcony and fantastic far-reaching views. There are two further bedrooms and a family bathroom.

OUTSIDE

The property is approached from the lane on to a drive where there is parking for several cars. There is a substantial workshop measuring nearly 1500 sq ft with secure roller doors, power and light. Inside, the building is divided into further secure workshops and garaging with the potential for alternative uses, subject to any necessary consents. A path from the parking area leads to the house. Immediately outside the house and accessed from the sitting room is a large south-facing terrace adjoining the garden and making the most of the super views. The main garden is to the east of the house and laid to lawn with a variety of fruit trees including cider, eating and cooking apple, pear and cherry trees, as well as an established vegetable plot. Beyond is a level field with a pond and established hedge boundaries. The pond is a delightful feature and a haven for wildlife with many breeding birds including wild Canadian geese, moorhens and ducks. There are 180 degree views over the Blackmore Vale countryside to the hills in the distance.





SITUATION

Manston is a rural village in The Blackmore Vale. There is the delightful Church of St. Nicholas and a well-known public house, The Plough.

More comprehensive facilities are available in the market town of Sturminster Newton about 3 miles away. The nearby village of Child Okeford has local facilities and the market towns of Shaftesbury and Blandford Forum are easily accessible, as well as Gillingham (7 miles) which has a mainline station to London Waterloo.

DIRECTIONS

What3words:///food.phantom.masterpiece

SERVICES

Mains water and electricity are connected to the property. Private drainage. Oil fired central heating system.

MATERIAL INFORMATION

Standard broadband is available. Fast dish broadband by Wessex Internet.

There is mobile coverage in the area, please refer to Ofcom's website for more details.

(Ofcom <https://www.ofcom.org.uk>)

Council Tax Band: D

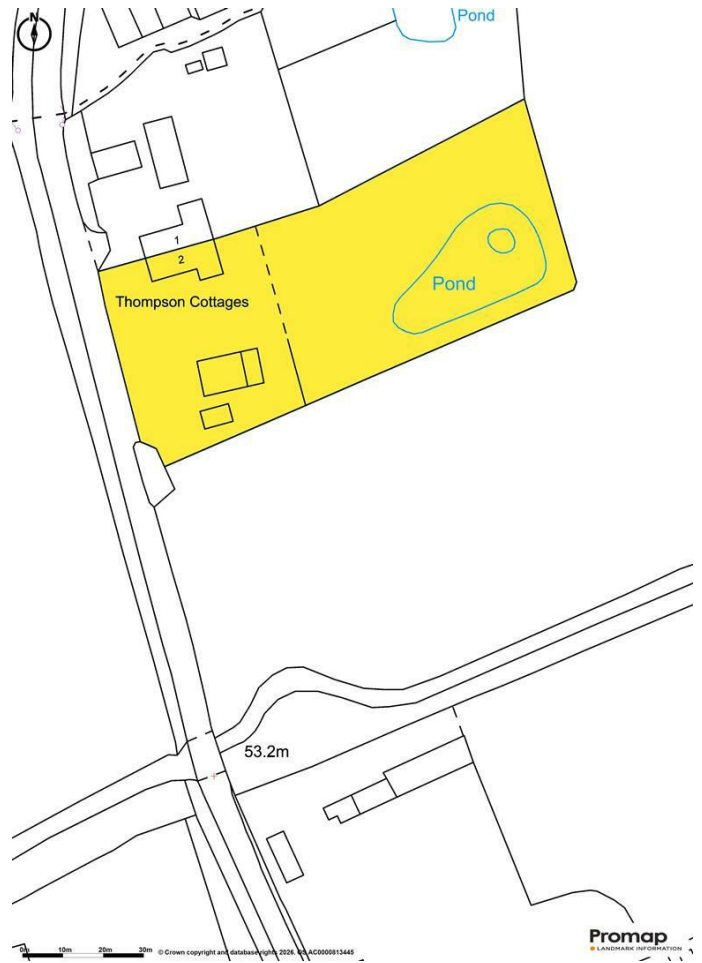

Manston, Sturminster Newton

Approximate Area = 2170 sq ft / 201.5 sq m
 Limited Use Area(s) = 46 sq ft / 4.2 sq m
 Garage = 1488 sq ft / 138.2 sq m
 Total = 3704 sq ft / 343.9 sq m
 For identification only - Not to scale



Denotes restricted head height

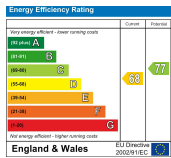
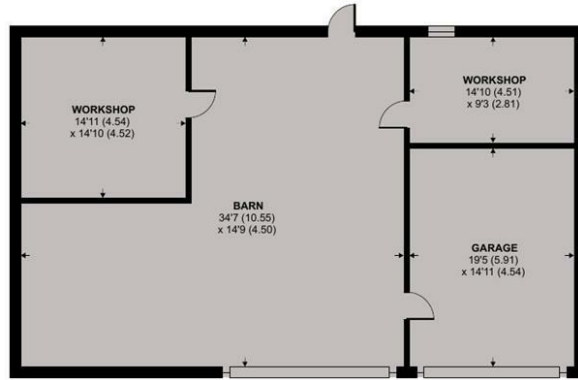

Floor plan produced in accordance with RICS Property Measurement 2nd Edition, Incorporating International Property Measurement Standards (IPMS2 Residential). © nctechcom 2026. Produced for Symonds & Sampson. REF: 1455275



STU/GWB/0626



01258 473766

sturminster@symondsandsampson.co.uk
 Symonds & Sampson LLP
 Agriculture House, Market Place,
 Sturminster Newton, Dorset DT10 1AR



Important Notice: Symonds & Sampson LLP and their clients give notice that they have no authority to make or give any representations or warranties regarding the property. These particulars do not form part of any offer or contract and must not be relied upon as statements of fact. Some descriptions and images may have been AI-assisted; while reviewed for accuracy, interested parties should verify key details through inspection or by contacting our agents. All measurements and distances are approximate. Text, photographs, and plans are for guidance only and may not be comprehensive. It should not be assumed that the property has all necessary planning or regulatory consents, and no services, equipment, or facilities have been tested. No investigations have been made into pollution or contamination; purchasers must make their own enquiries. The property is sold subject to all existing wayleaves, easements, and rights of way (public or private), whether mentioned or not. Vendors are not required to define such rights.

SALES | LETTINGS | AUCTIONS | FARMS & LAND | COMMERCIAL | NEW HOMES | PLANNING & DEVELOPMENT