



TO LET

£1,200 Per Calendar Month

## The Loft Rock Farm Barns, St Martins, Oswestry, Shropshire, SY11 3DT

A recently renovated, three bedroom barn conversion situated in the heart of the Shropshire countryside, boasting stunning interiors, off street parking, and spectacular rural views.





- Barn Conversion
- Beautifully Presented
- Rural Location
- Countryside Views
- Off Street Parking
- Available May 2026

## DESCRIPTION

Situated in a stunning, rural setting just outside of the popular village of St.Martins, which benefits from a range of amenities, including schools, shops, and restaurants, whilst also retaining convenient road links to the larger towns of Ellesmere and Oswestry. Having undergone a complete and sympathetic renovation, the property now boasts bathrooms, kitchen, and décor, these complimented by a number of original features. The property also offers use of off street parking.

## OPENPLAN LIVING/KITCHEN/DINING AREA

38'3" x 15'7" (11.66 x 4.76)

## MAIN BEDROOM

12'1" x 11'5" (3.69 x 3.48)

## EN-SUITE

10'7" x 3'8" (3.22 x 1.11)

## BEDROOM TWO

12'1" x 11'5" (3.69 x 3.48)

## FAMILY BATHROOM

5'11" x 7'11" (1.80 x 2.41)

## BEDROOM THREE

8'0" x 11'3" (2.44 x 3.44)

## FURNISHINGS

The property will be offered partially furnished although certain items can be removed by negotiation.

## HOLDING DEPOSIT

An initial holding deposit equal to one week's rent will be due upon application.

## SECURITY DEPOSIT

A security deposit equal to five weeks' rent will be due to be held by the DPS.

## LOCAL AUTHORITY

Shropshire Council, Shirehall, Abbey Foregate, Shrewsbury, Shropshire, SY2 6ND



0 Reception  
Room/s



3 Bedroom/s



2 Bath/Shower  
Room/s



### **COUNCIL TAX**

The property is listed as a band D on the local authority register.

### **TERMS**

The property will be offered on an initial six month AST.

Pets to be declared prior to viewing.

### **VIEWINGS**

By appointment through Halls, The Square, Ellesmere, Shropshire, SY12 0AW

### **N.B**

Potential applicants are advised that there is no dedicated garden space for the property.

Viewers are advised that the photos used were taken in 2024

The Loft Rock Farm Barns, St Martins, Oswestry, Shropshire, SY11 3DT

Basement  
656 sq.ft. (61.0 sq.m.) approx.

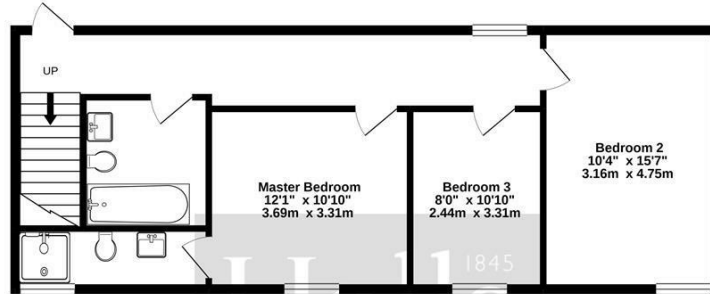

Ground Floor  
638 sq.ft. (59.3 sq.m.) approx.

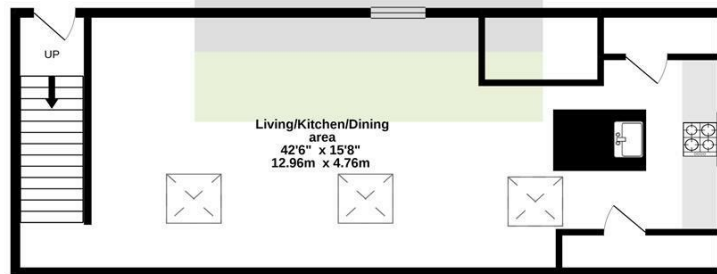

TOTAL FLOOR AREA: 1,294 sq.ft. (120.2 sq.m.) approx.  
Whilst every attempt has been made to ensure the accuracy of the figures contained here, measurements of doors, windows, rooms and any other items are approximate and no responsibility is taken for any error, omission or misstatement. This plan is for guidance purposes only and should be used as such by any prospective purchaser. The services, systems and appliances shown have not been tested and no guarantee is given as to their operability or efficiency. See the green.  
Made with Metreapp ©2021

**Property to sell?** We would be delighted to provide you with a free no obligation market assessment of your existing property. Please contact your local Halls office to make an appointment. **Mortgage/ financial advice.** We are able to recommend a completely independent financial advisor,

who is authorised and regulated by the FCA. Details can be provided upon request. **Do you require a surveyor?** We are able to recommend a completely independent chartered surveyor. Details can be provided upon request.

Energy Performance Ratings

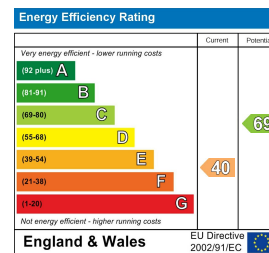

01691 622602

**Ellesmere Lettings**  
1-3 Cross Street, Ellesmere, Shropshire, SY12 0AW  
E: ellesmerelettings@hallsgb.com



IMPORTANT NOTICE. Halls Holdings Ltd and any joint agents for themselves, and for the Vendor of the property whose Agents they are, give notice that: (i) These particulars are produced in good faith, are set out as a general guide only and do not constitute any part of a contract (ii) No person in the employment of or any agent of or consultant to Halls Holdings has any authority to make or give any representation or warranty whatsoever in relation to this property (iii) Measurements, areas and distances are approximate. Floor plans and photographs are for guidance purposes only (photographs are taken with a wide angled / zoom lenses) and dimensions shapes and precise locations may differ (iv) It must not be assumed that the property has all the required planning or building regulation consents. Halls Holdings, Bowmen Way, Shrewsbury, Shropshire SY4 3DR. Registered in England 06597073.