



See More Online

KFB: Key Facts For Buyers

A Guide to This Property & the Local Area
Friday 26th June 2026



SHROPHAM ROAD, GREAT HOCKHAM, THETFORD, IP24

Whittley Parish | Attleborough

Suva House, Queens Square Attleborough NR17 2AF

01953 711839

nick@whittleyparish.com

www.whittleyparish.com





Property

Type:	Detached	Tenure:	Freehold
Bedrooms:	4		
Plot Area:	0.32 acres		
Council Tax :	Band Deleted		
Title Number:	NK134649		

Local Area

Local Authority:	Norfolk
Conservation Area:	Hockham
Flood Risk:	
• Rivers & Seas	Very low
• Surface Water	Very low

Estimated Broadband Speeds (Standard - Superfast - Ultrafast)

18 mb/s	62 mb/s	1000 mb/s

Mobile Coverage: (based on calls indoors)



Satellite/Fibre TV Availability:



Planning History

This Address



Planning records for: *Shropham Road, Great Hockham, Thetford, IP24*

Reference - TRE/2013/0140/TCA
Decision: CA No Objection
Date: 07th November 2013
Description: x1 Silver Birch - fell to ground level and remove







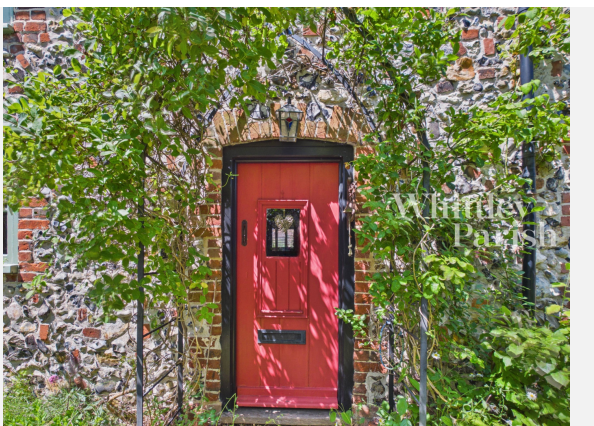





SHROPHAM ROAD, GREAT HOCKHAM, THETFORD, IP24

<p>Floor 0 Building 1</p>	<p>Floor 1 Building 1</p>	<p>Approximate total area⁽¹⁾ 3294 ft²</p> <p>Reduced headroom 19 ft²</p>
<p>Floor 0 Building 2</p>	<p>Floor 0 Building 3</p>	
<p>Floor 0 Building 4</p>		
		<p>(1) Excluding balconies and terraces</p>
		<p>Reduced headroom ----- Below 5 ft</p>
		<p>Calculations reference the RICS IPMS 3C standard. Measurements are approximate and not to scale. This floor plan is intended for illustration only.</p> <p>GIRAFFE360</p>



SHROPHAM ROAD, GREAT HOCKHAM, THETFORD, IP24





SHROPHAM ROAD, GREAT HOCKHAM, THETFORD, IP24



SHROPHAM ROAD, GREAT HOCKHAM, THETFORD, IP24

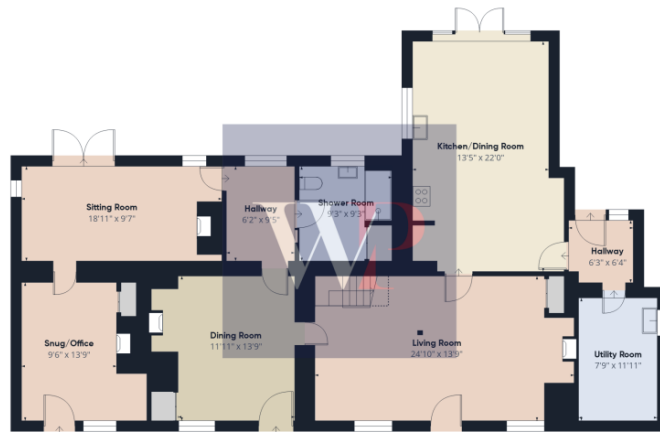

Floor 0 Building 1

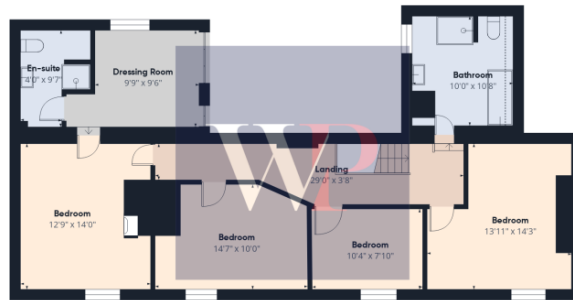

Floor 1 Building 1

Approximate total area⁽¹⁾
2359 ft²
Reduced headroom
19 ft²

(1) Excluding balconies and terraces

Reduced headroom
..... Below 5 ft

Calculations reference the RICS IPMS 3C standard. Measurements are approximate and not to scale. This floor plan is intended for illustration only.

GIRAFFE360



SHROPHAM ROAD, GREAT HOCKHAM, THETFORD, IP24

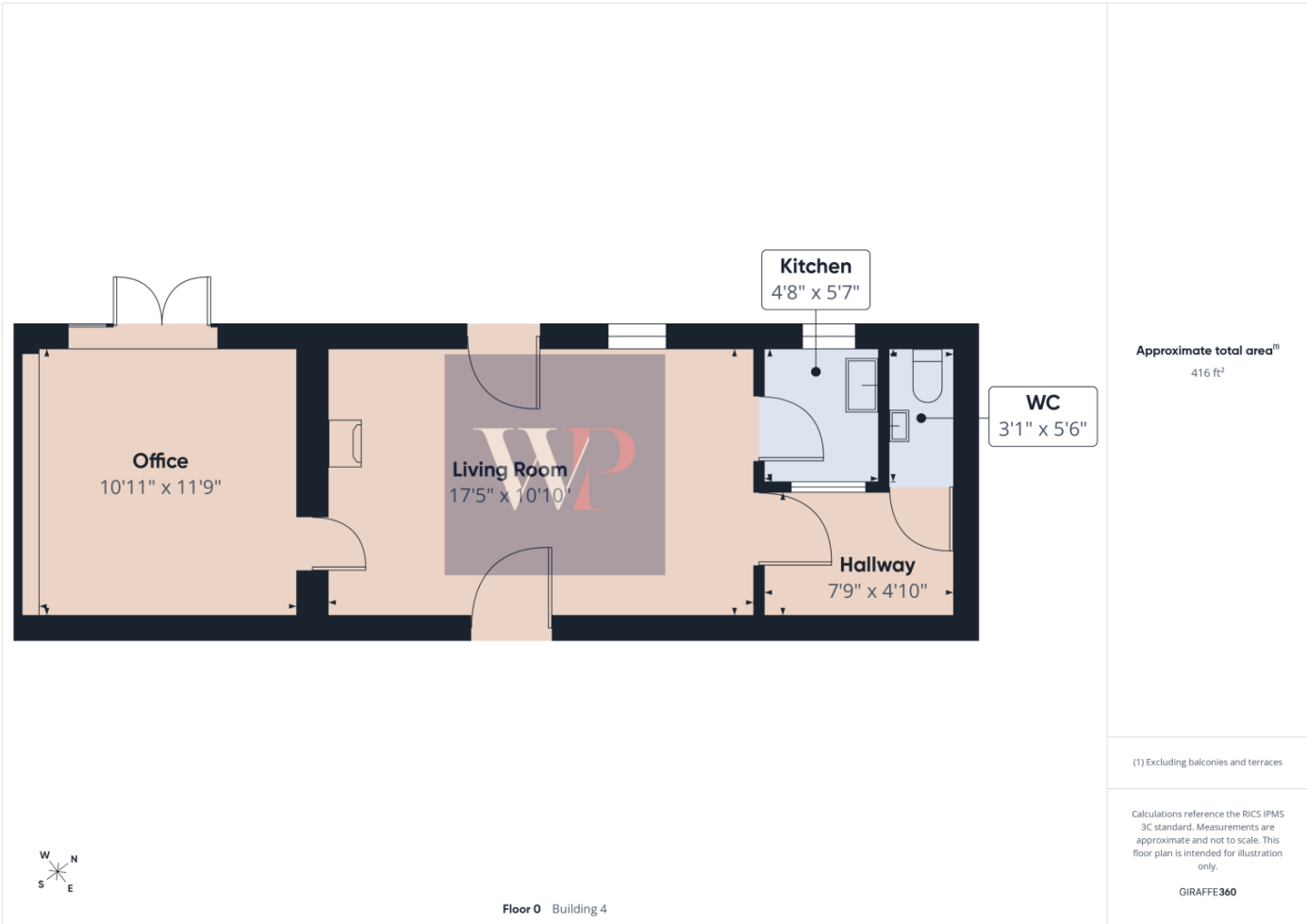

Market

House Price Statistics



10 Year History of Average House Prices by Property Type in IP24

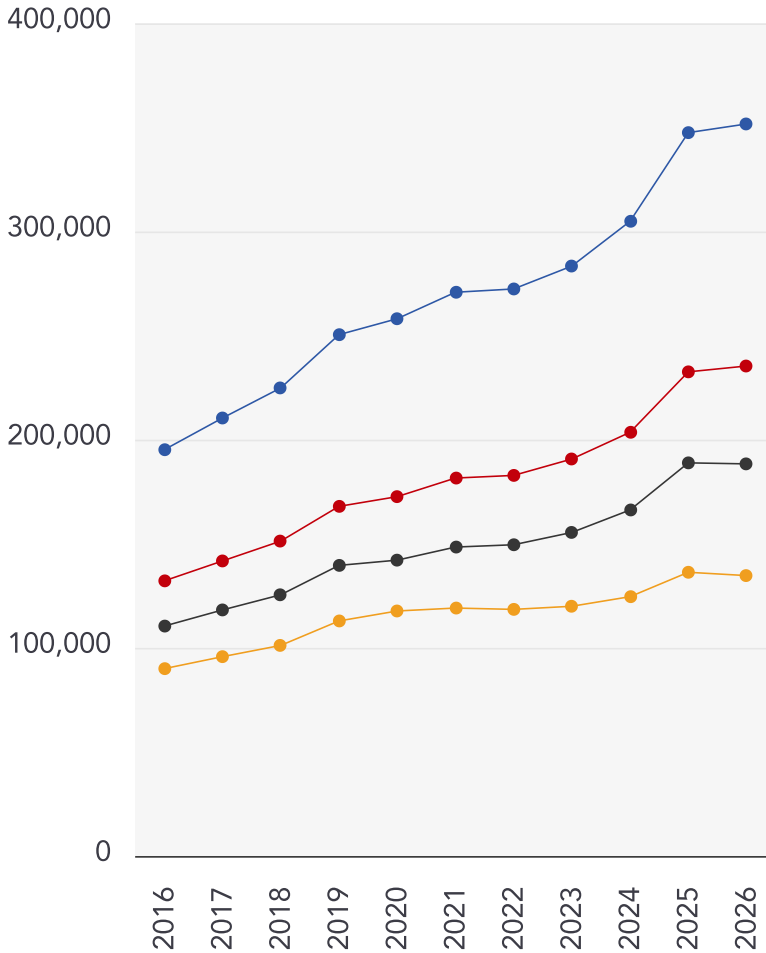

Detached

+80.17%

Semi-Detached

+78.07%

Terraced

+70.53%

Flat

+49.65%

Maps

Coal Mining



This map displays nearby coal mine entrances and their classifications.

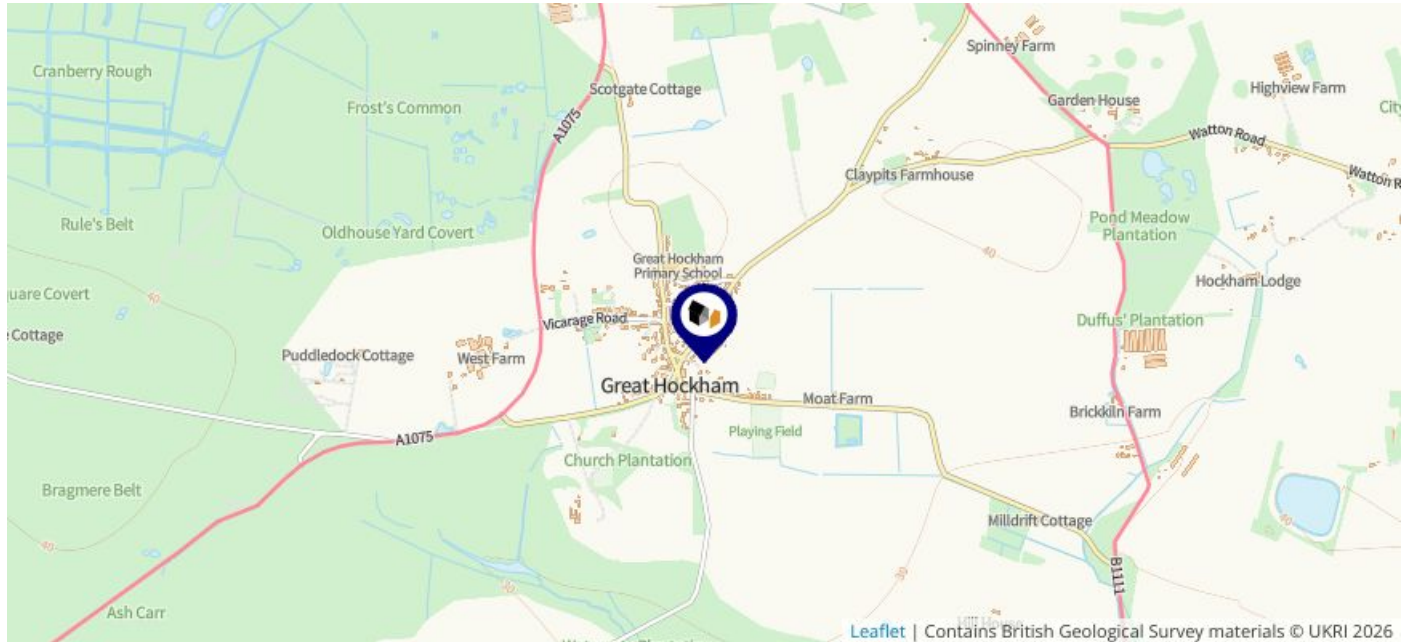

Mine Entry

- ✕ Adit
- ✕ Gutter Pit
- ✕ Shaft

The Coal Authority has records of over 175,000 mine entries within the UK captured in the National Coal Mining database, derived from sources including abandonment plans, geological and topographical plans.

Coal mining activity is recorded as far back as the 13th century, but prior to 1872 there was no requirement to deposit abandonment plans. It is therefore believed there may be many unrecorded mine entries of which the Authority has no information or knowledge. These entries do not, therefore, appear within the Authority's national dataset as shown on this map.

Maps

Conservation Areas



This map displays nearby official conservation areas. Every local authority in England has at least one conservation area. Most are designated by the Council as the local planning authority, though Historic England and the Secretary of State also have the power to create them.

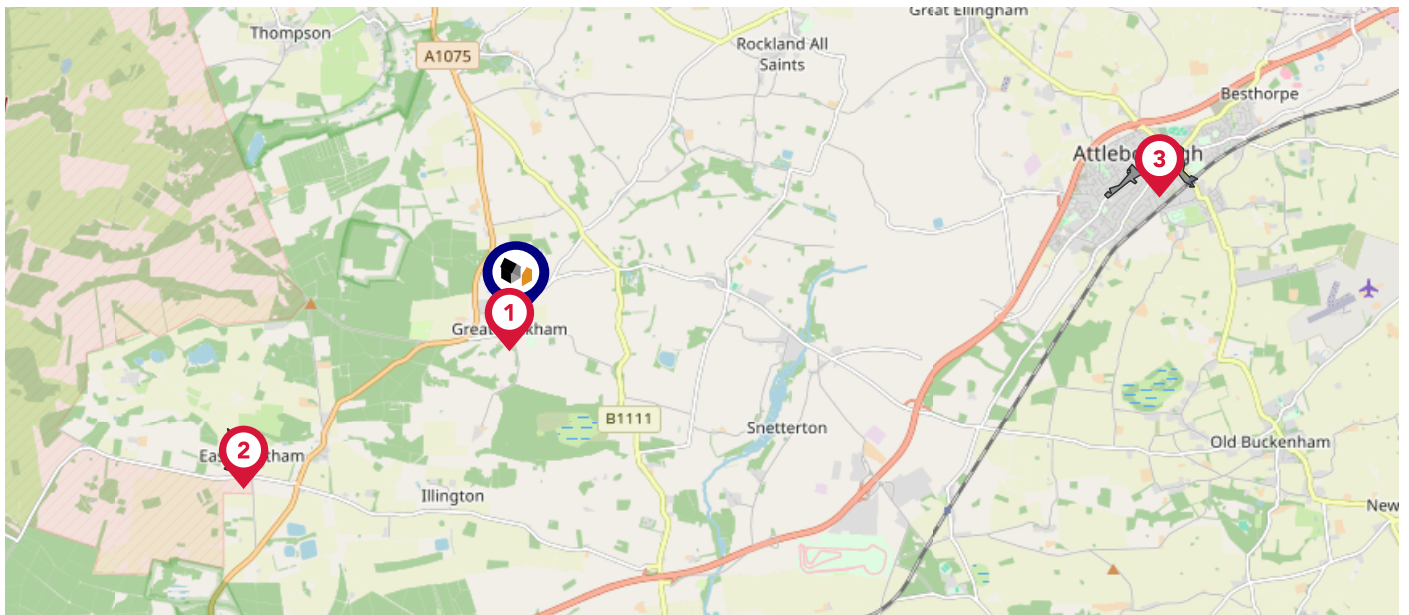

Nearby Conservation Areas



Hockham



East Wretham



Attleborough

Maps

Council Wards



The UK is divided into wards that are used for local elections to elect local government councillors. Sometimes these are known as 'electoral divisions'. Population counts can vary substantially between wards, but the national average is about 5,500

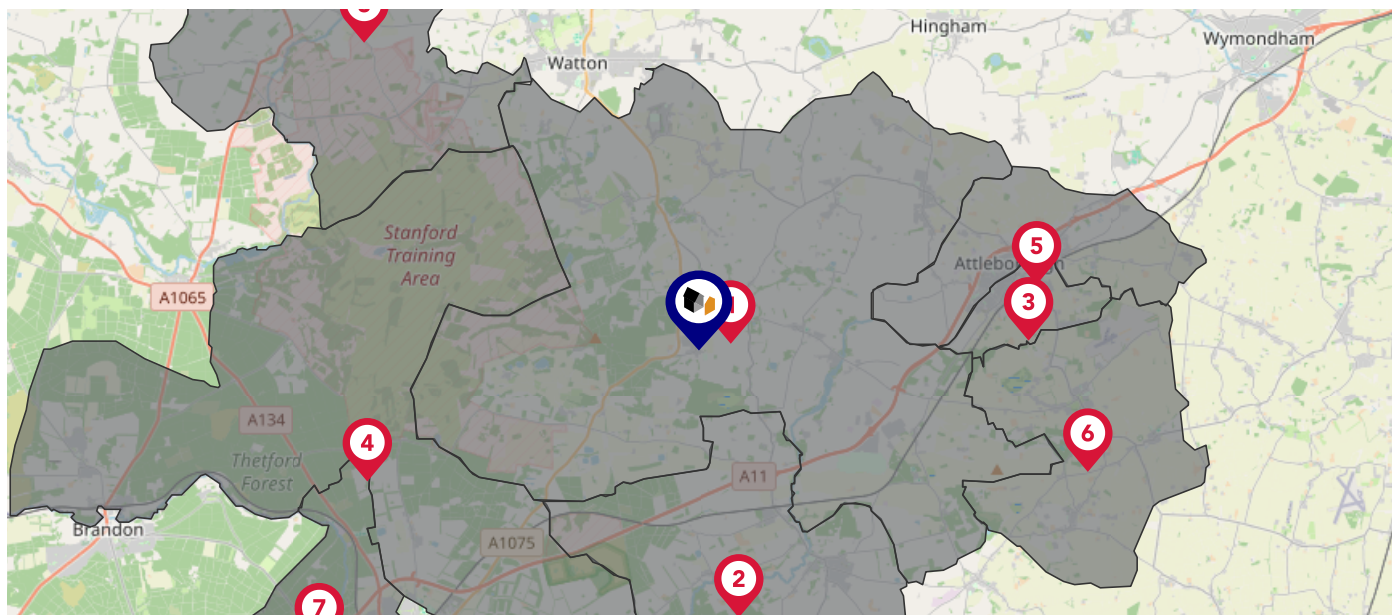

Nearby Council Wards

- 1 All Saints & Wayland Ward
- 2 Harling & Heathlands Ward
- 3 Attleborough Burgh & Haverscroft Ward
- 4 Forest Ward
- 5 Attleborough Queens & Besthorpe Ward
- 6 The Buckenham & Banham Ward
- 7 Thetford Priory Ward
- 8 Ashill Ward



This map displays the noise levels from nearby network rail and HS1 railway routes that affect this property...

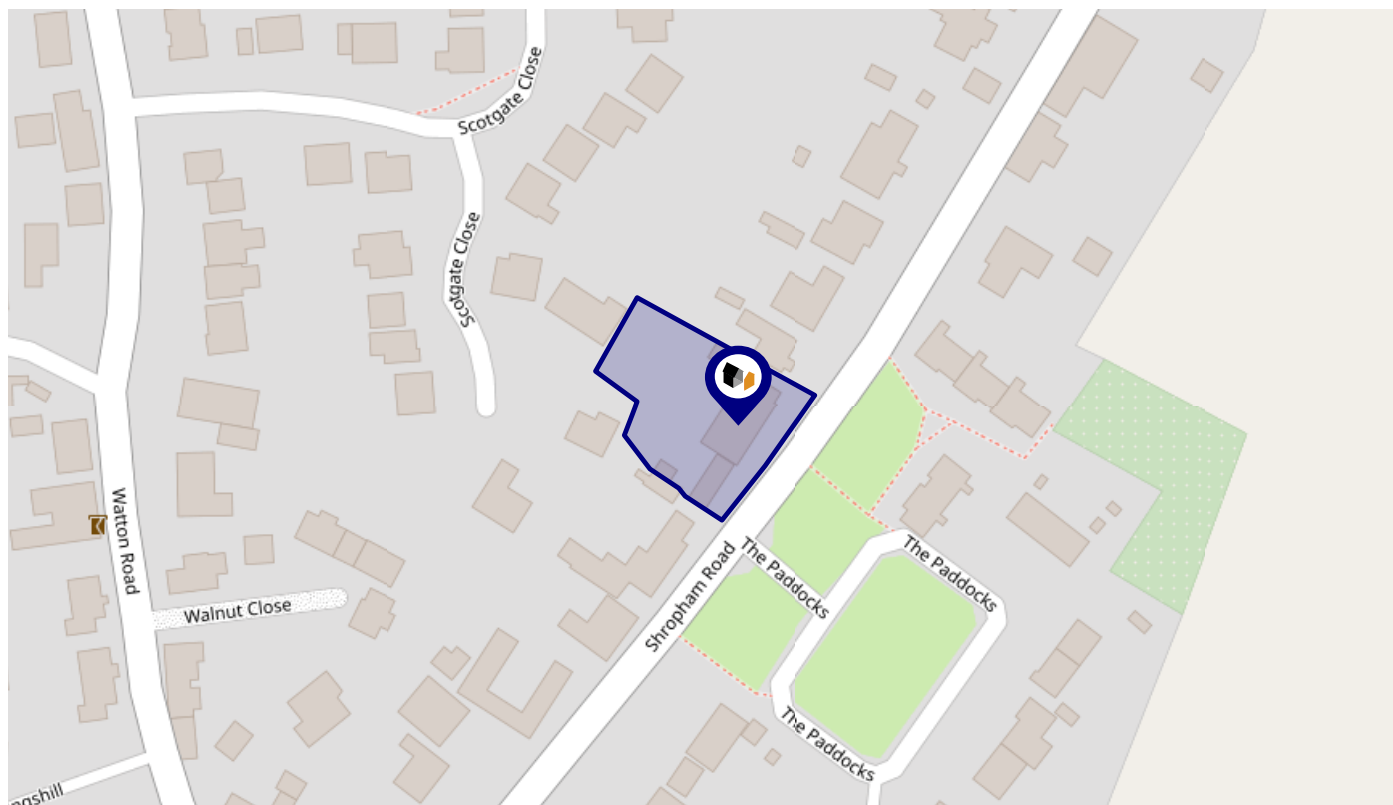

Rail Noise Data

This data indicates the level of noise according to the strategic noise mapping of rail sources within areas with a population of at least 100,000 people (agglomerations) and along Network Rail and HS1 traffic routes.

The data indicates the annual average noise levels for the 16-hour period between 0700 - 2300.

Noise levels are modelled on a 10m grid at a receptor height of 4m above ground, polygons are then produced by merging neighbouring cells within the following noise classes:

5		75.0+ dB	■
4		70.0-74.9 dB	■
3		65.0-69.9 dB	■
2		60.0-64.9 dB	■
1		55.0-59.9 dB	■

Flood Risk

Rivers & Seas - Flood Risk



This map shows the chance of flooding from rivers and / or the sea, taking into account flood defences and their condition.

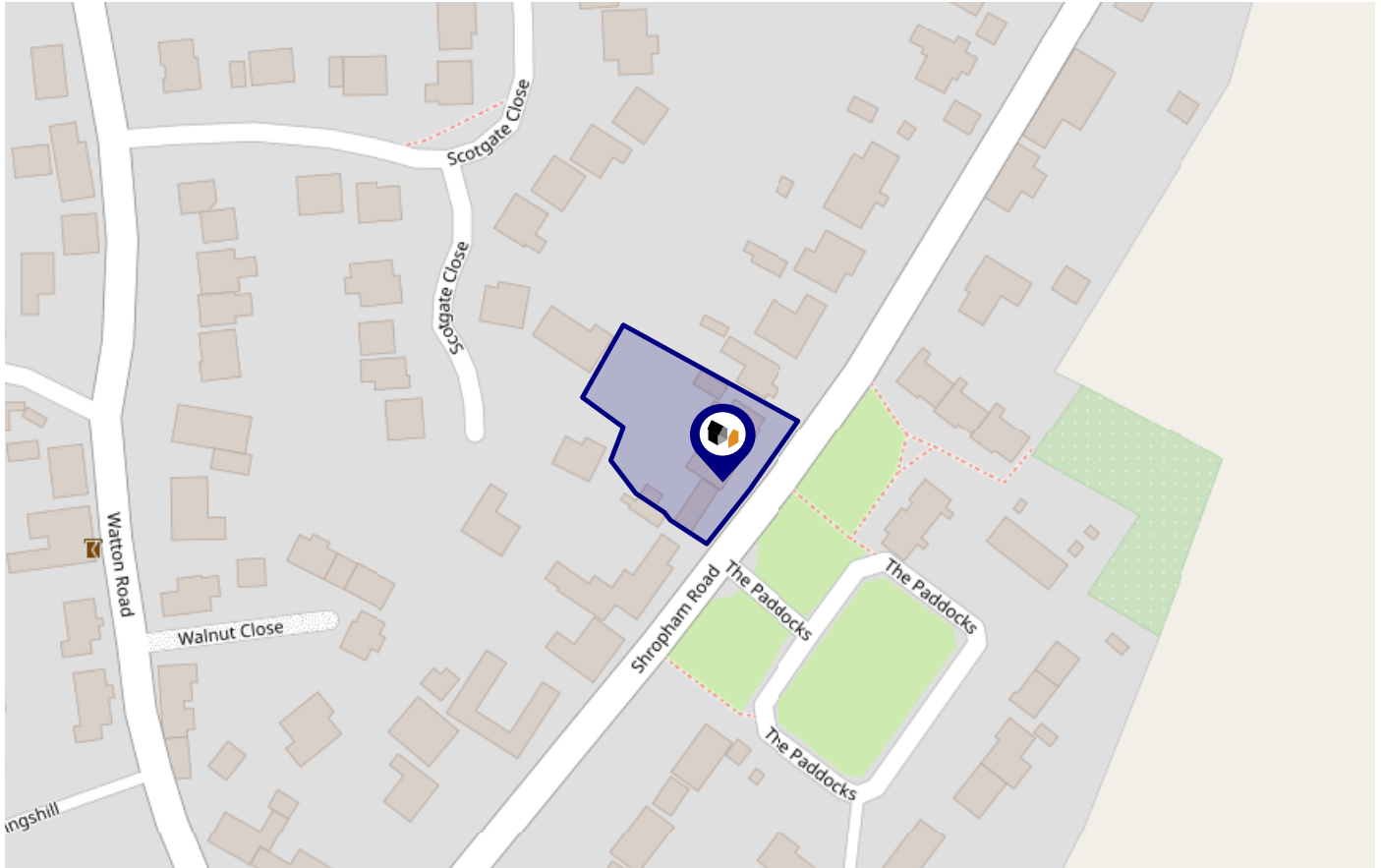

Risk Rating: Very low

The map does not contain sufficient information for it to be used to determine flood risk to individual properties, but it does give you an indication of whether your area may be affected by surface water flooding at this risk level.

- **High Risk** - an area which has a chance of flooding of greater than 1 in 30 (3.3%) in any one year.
- **Medium Risk** - an area which has a chance of flooding of greater than 1 in 100 (1.0%) in any one year.
- **Low Risk** - an area which has a chance of flooding of greater than 1 in 1000 (0.1%) in any one year.
- **Very Low Risk** - an area in which the risk is below 1 in 1000 (0.1%) in any one year.

Chance of flooding to the following depths at this property:

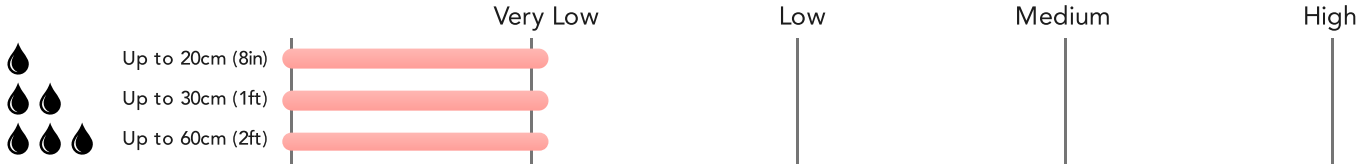

Flood Risk

Rivers & Seas - Climate Change



This map shows the future chance of flooding from rivers and / or the sea **between 2036 and 2069**, taking into account flood defences and their condition. The government climate change models cannot predict exactly when the chance of flooding will go up. It could happen at any time during the time period.

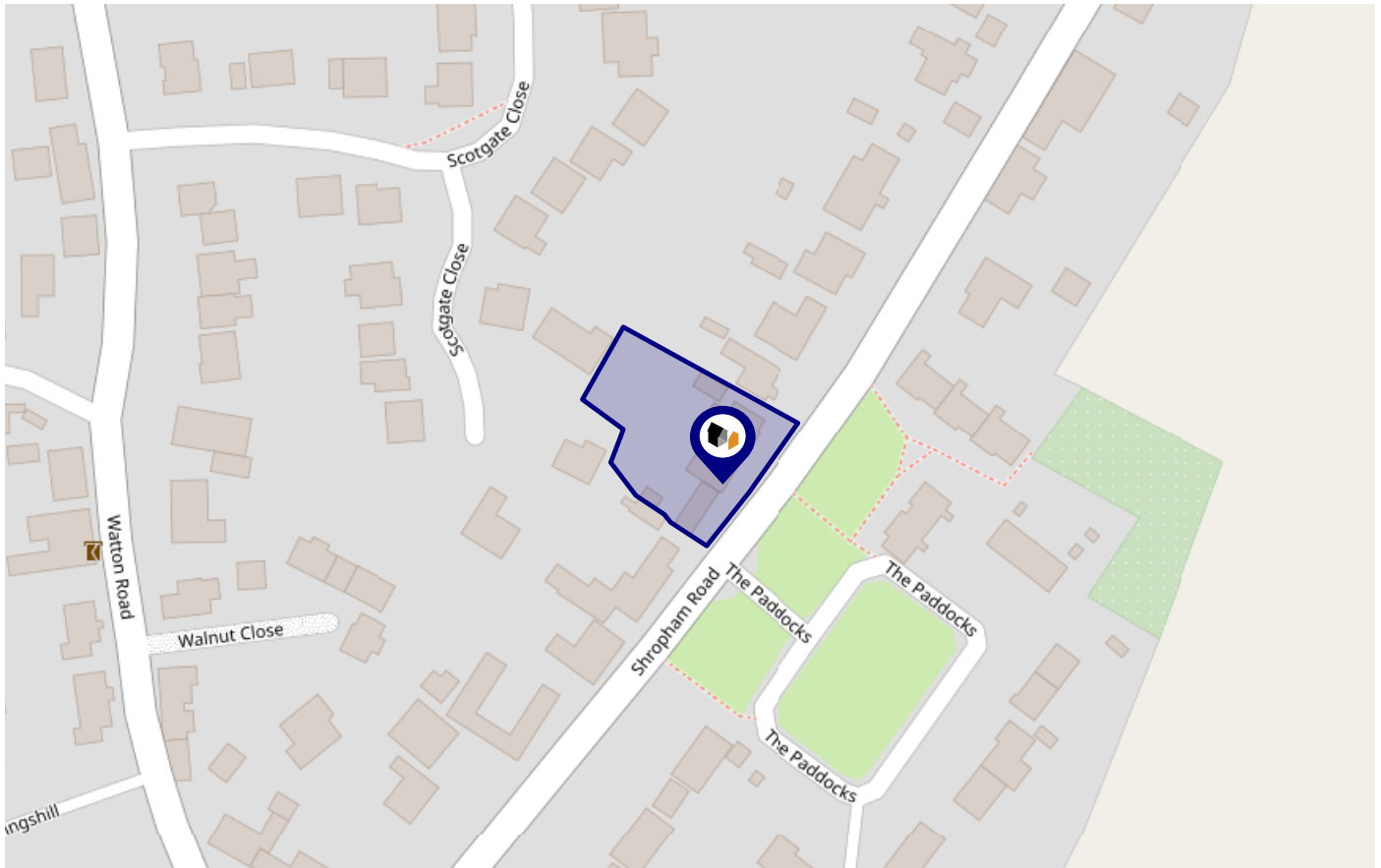

Risk Rating: Very low

The map does not contain sufficient information for it to be used to determine flood risk to individual properties, but it does give you an indication of whether your area may be affected by surface water flooding at this risk level.

- High Risk** - an area which has a chance of flooding of greater than 1 in 30 (3.3%) in any one year.
- Medium Risk** - an area which has a chance of flooding of greater than 1 in 100 (1.0%) in any one year.
- Low Risk** - an area which has a chance of flooding of greater than 1 in 1000 (0.1%) in any one year.
- Very Low Risk** - an area in which the risk is below 1 in 1000 (0.1%) in any one year.

Chance of flooding to the following depths at this property:



Flood Risk

Surface Water - Flood Risk

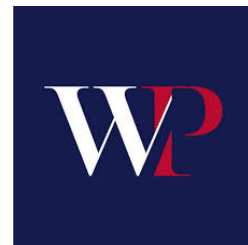

This map shows the chance of flooding where rainwater has nowhere to drain. This kind of flooding can occur far from rivers or seas.

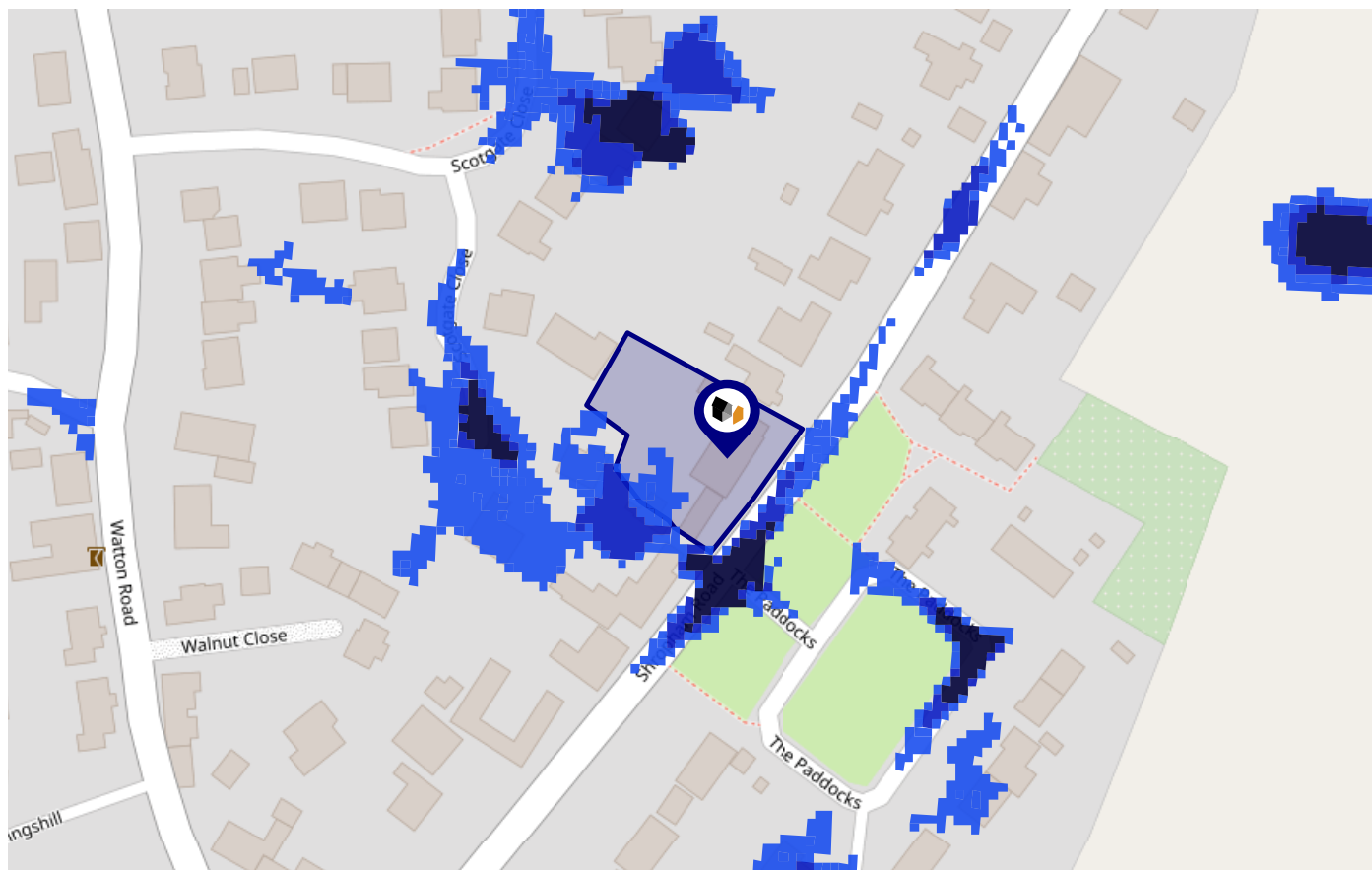

Risk Rating: Very low

The map does not contain sufficient information for it to be used to determine flood risk to individual properties, but it does give you an indication of whether your area may be affected by surface water flooding at this risk level.

- High Risk** - an area which has a chance of flooding of greater than 1 in 30 (3.3%) in any one year.
- Medium Risk** - an area which has a chance of flooding of greater than 1 in 100 (1.0%) in any one year.
- Low Risk** - an area which has a chance of flooding of greater than 1 in 1000 (0.1%) in any one year.
- Very Low Risk** - an area in which the risk is below 1 in 1000 (0.1%) in any one year.

Chance of flooding to the following depths at this property:

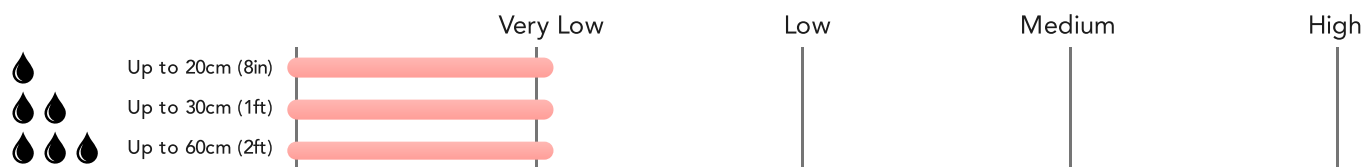

Flood Risk

Surface Water - Climate Change

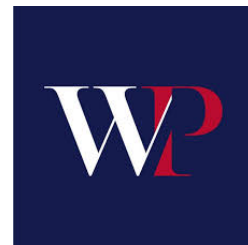

This map shows the future chance of flooding **between 2040 and 2060** where rainwater has nowhere to drain. This kind of flooding can occur far from rivers or seas. The government climate change models cannot predict exactly when the chance of flooding will go up. It could happen at any time during the time period.

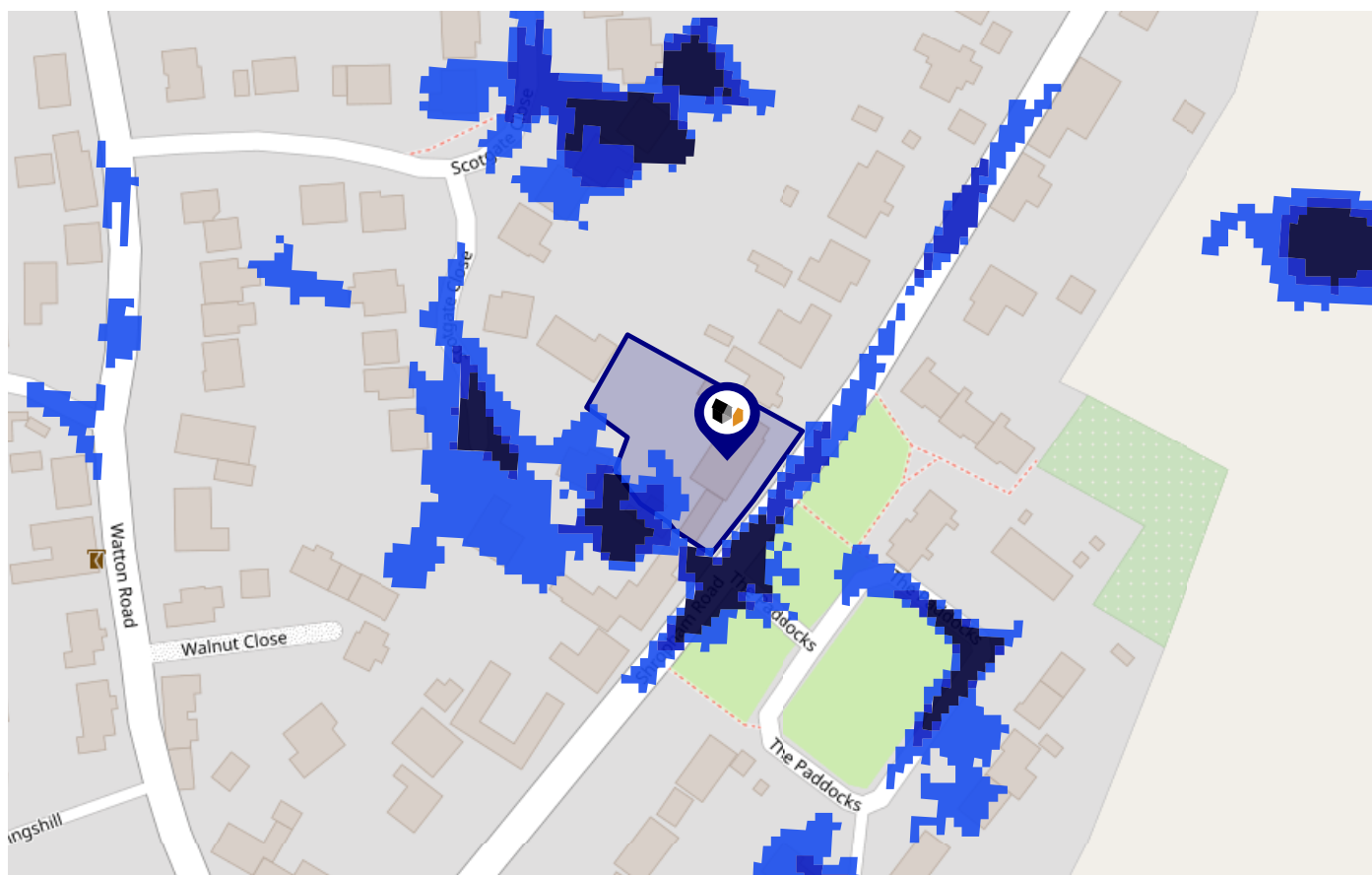

Risk Rating: Very low

The map does not contain sufficient information for it to be used to determine flood risk to individual properties, but it does give you an indication of whether your area may be affected by surface water flooding at this risk level.

- High Risk** - an area which has a chance of flooding of greater than 1 in 30 (3.3%) in any one year.
- Medium Risk** - an area which has a chance of flooding of greater than 1 in 100 (1.0%) in any one year.
- Low Risk** - an area which has a chance of flooding of greater than 1 in 1000 (0.1%) in any one year.
- Very Low Risk** - an area in which the risk is below 1 in 1000 (0.1%) in any one year.

Chance of flooding to the following depths at this property:

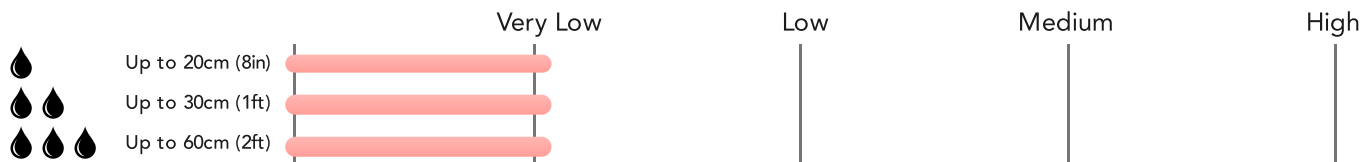

Maps

Green Belt



This map displays nearby areas that have been designated as Green Belt...

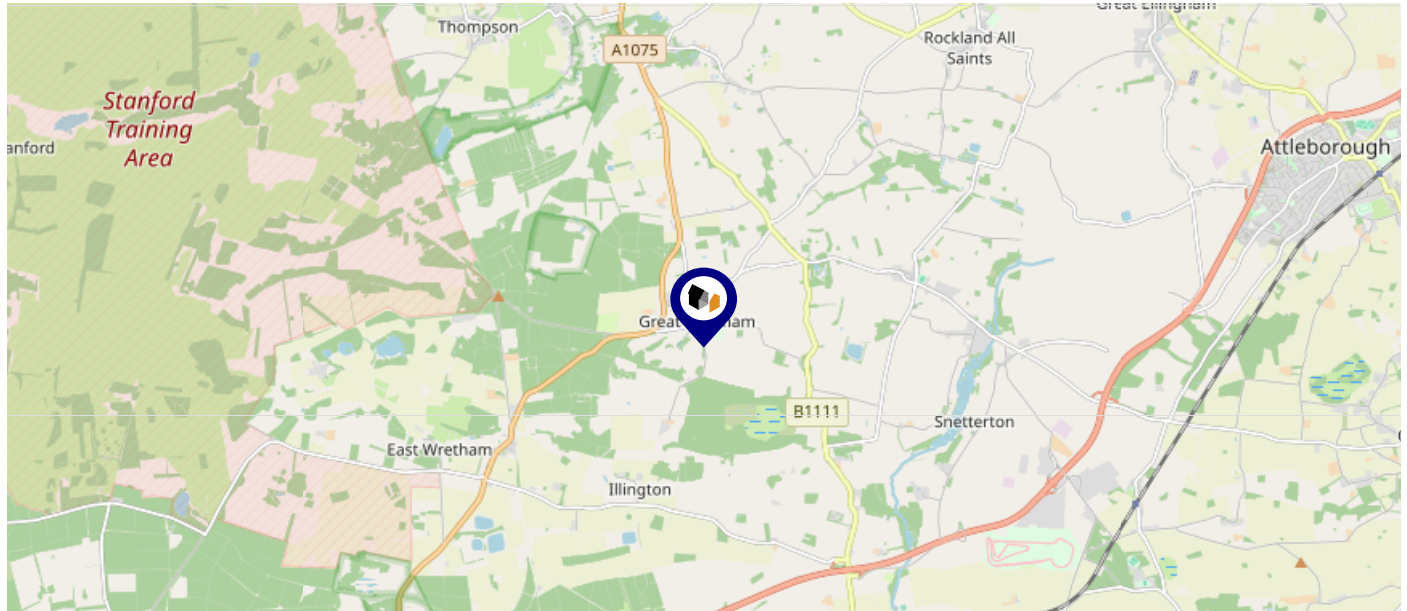

Nearby Green Belt Land

No data available.

Maps

Landfill Sites



This map displays the location of known landfill sites. Historic sites are where there is no environmental permit in force. Active sites are currently authorised by the Environment Agency under Environmental Permitting Regulations.

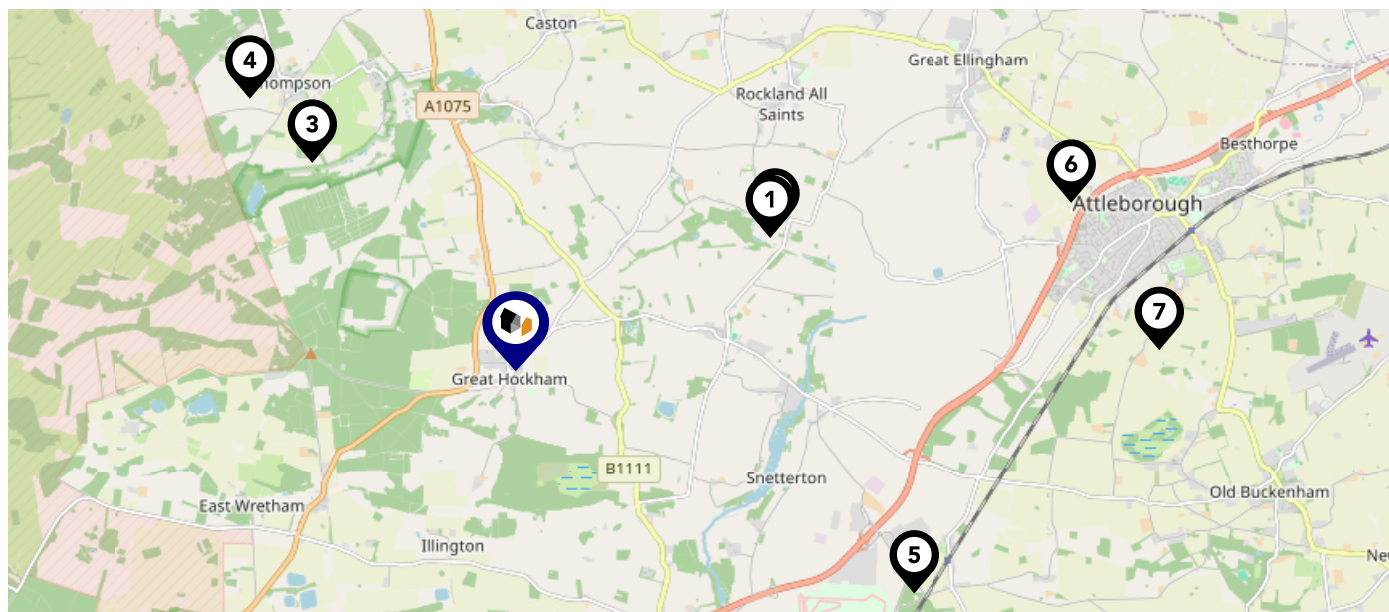

Nearby Landfill Sites

1	Rocklands-Rocklands, Breckland	Historic Landfill
2	Mount Pleasant Quarry-Rocklands, Attleborough	Historic Landfill
3	Red Brick Farm Site B-Red Brick Farm	Historic Landfill
4	Red Brick Farm Site A-Red Brick Farm, Thompson	Historic Landfill
5	EA/EPR/CP3796SC/V002	Active Landfill
6	Crowshall Lane-Attleborough, Norfolk	Historic Landfill
7	Attleborough-Attleborough, Norfolk	Historic Landfill









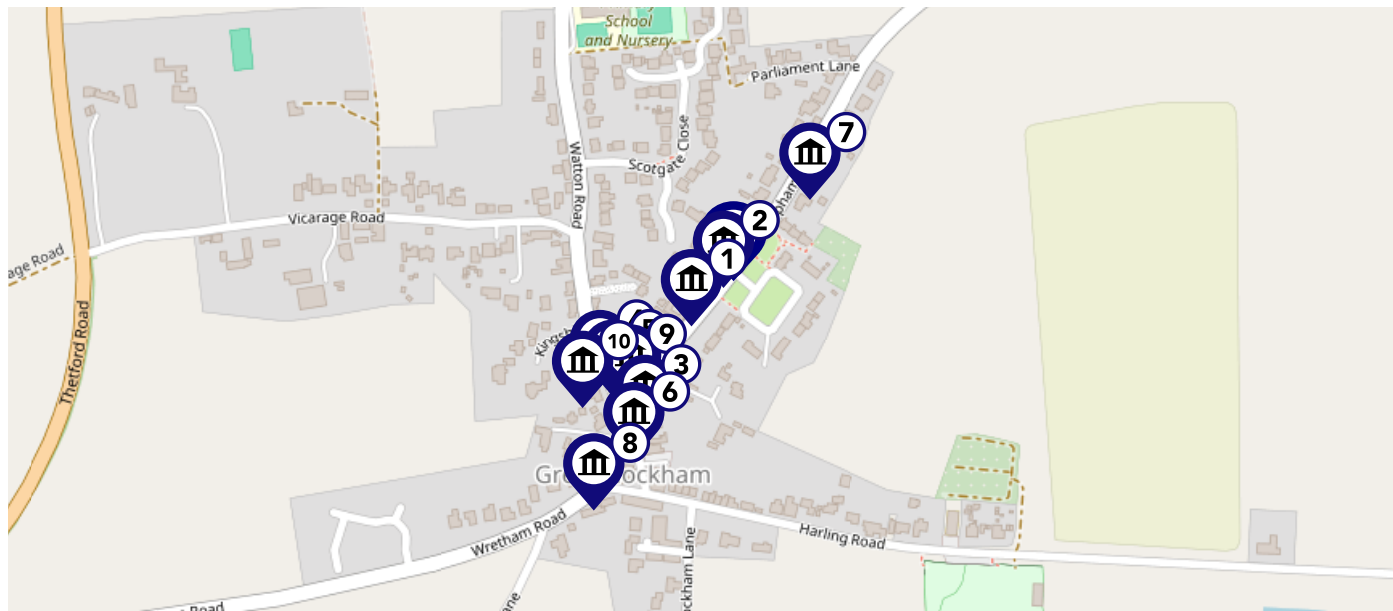

Maps

Listed Buildings



This map displays nearby listed buildings and protected structures, as well as their listed tier and distance from the target property...



Listed Buildings in the local district	Grade	Distance
 1248442 - Briardene	Grade II	0.0 miles
 1077544 - Flint Cottages	Grade II	0.0 miles
 1342459 - The Cottage	Grade II	0.1 miles
 1077571 - Hill Cottage	Grade II	0.1 miles
 1342460 - Cleobury Cottage	Grade II	0.1 miles
 1077569 - St Margaret	Grade II	0.1 miles
 1393507 - Barn At North Farm	Grade II	0.1 miles
 1277964 - 16 And 17, School Square	Grade II	0.1 miles
 1077570 - The Old Red Lion Inn	Grade II	0.1 miles
 1342428 - K6 Telephone Kiosk	Grade II	0.1 miles



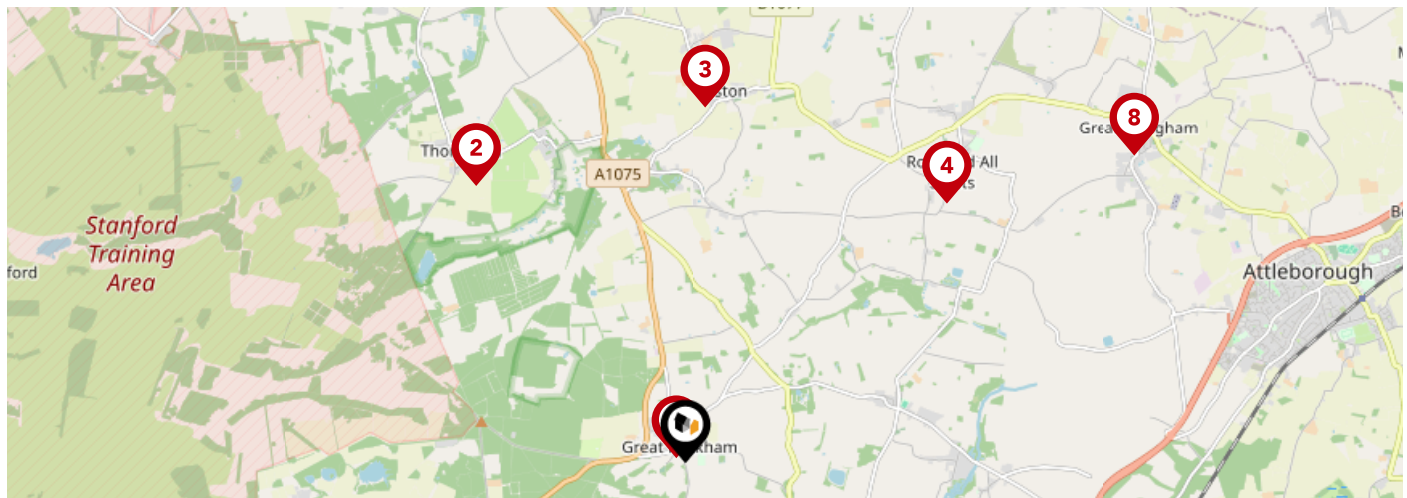



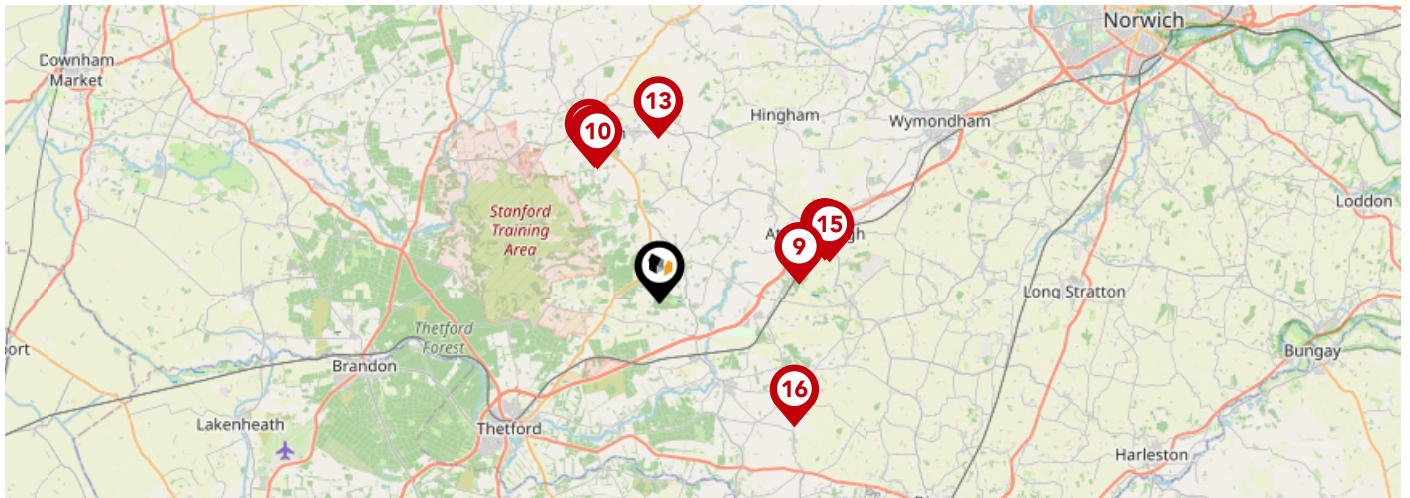

Area Schools



	Nursery	Primary	Secondary	College	Private
<p>1 Great Hockham Primary School and Nursery Ofsted Rating: Good Pupils: 110 Distance:0.1</p>	<input type="checkbox"/>	<input checked="" type="checkbox"/>	<input type="checkbox"/>	<input type="checkbox"/>	<input type="checkbox"/>
<p>2 Thompson Primary School Ofsted Rating: Requires improvement Pupils: 87 Distance:3.14</p>	<input type="checkbox"/>	<input checked="" type="checkbox"/>	<input type="checkbox"/>	<input type="checkbox"/>	<input type="checkbox"/>
<p>3 Caston Church of England Primary Academy Ofsted Rating: Good Pupils: 72 Distance:3.21</p>	<input type="checkbox"/>	<input checked="" type="checkbox"/>	<input type="checkbox"/>	<input type="checkbox"/>	<input type="checkbox"/>
<p>4 Rocklands Community Primary School Ofsted Rating: Good Pupils: 71 Distance:3.32</p>	<input type="checkbox"/>	<input checked="" type="checkbox"/>	<input type="checkbox"/>	<input type="checkbox"/>	<input type="checkbox"/>
<p>5 East Harling Primary School and Nursery Ofsted Rating: Good Pupils: 212 Distance:4.7</p>	<input type="checkbox"/>	<input checked="" type="checkbox"/>	<input type="checkbox"/>	<input type="checkbox"/>	<input type="checkbox"/>
<p>6 Aurora White House School Ofsted Rating: Good Pupils: 61 Distance:4.75</p>	<input type="checkbox"/>	<input type="checkbox"/>	<input checked="" type="checkbox"/>	<input type="checkbox"/>	<input type="checkbox"/>
<p>7 Aurora Eccles School Ofsted Rating: Not Rated Pupils: 202 Distance:4.75</p>	<input type="checkbox"/>	<input type="checkbox"/>	<input checked="" type="checkbox"/>	<input type="checkbox"/>	<input type="checkbox"/>
<p>8 Great Ellingham Primary School Ofsted Rating: Good Pupils: 177 Distance:4.9</p>	<input type="checkbox"/>	<input checked="" type="checkbox"/>	<input type="checkbox"/>	<input type="checkbox"/>	<input type="checkbox"/>

Area Schools



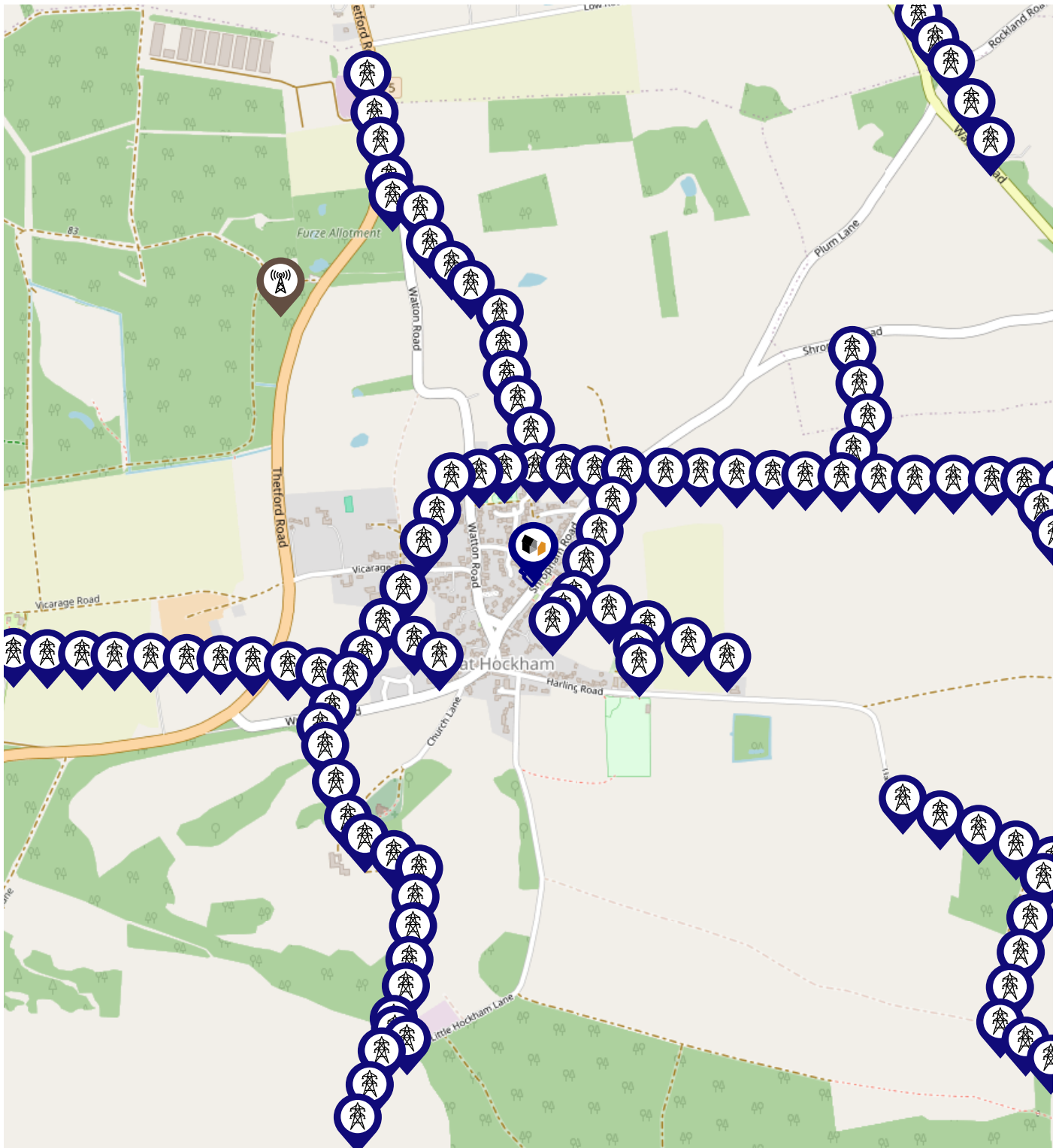

	Nursery	Primary	Secondary	College	Private
 Rosecroft Primary School Ofsted Rating: Requires improvement Pupils: 525 Distance:5.06	<input type="checkbox"/>	<input checked="" type="checkbox"/>	<input type="checkbox"/>	<input type="checkbox"/>	<input type="checkbox"/>
 Wayland Academy Ofsted Rating: Good Pupils: 569 Distance:5.34	<input type="checkbox"/>	<input type="checkbox"/>	<input checked="" type="checkbox"/>	<input type="checkbox"/>	<input type="checkbox"/>
 Watton Westfield Infant and Nursery School Ofsted Rating: Good Pupils: 294 Distance:5.45	<input type="checkbox"/>	<input checked="" type="checkbox"/>	<input type="checkbox"/>	<input type="checkbox"/>	<input type="checkbox"/>
 Watton Junior School Ofsted Rating: Not Rated Pupils: 284 Distance:5.75	<input type="checkbox"/>	<input checked="" type="checkbox"/>	<input type="checkbox"/>	<input type="checkbox"/>	<input type="checkbox"/>
 St Peter and St Paul Church of England Primary Academy & Nursery Ofsted Rating: Good Pupils: 191 Distance:5.96	<input type="checkbox"/>	<input checked="" type="checkbox"/>	<input type="checkbox"/>	<input type="checkbox"/>	<input type="checkbox"/>
 Attleborough Academy Ofsted Rating: Good Pupils: 932 Distance:6.16	<input type="checkbox"/>	<input type="checkbox"/>	<input checked="" type="checkbox"/>	<input type="checkbox"/>	<input type="checkbox"/>
 Attleborough Primary School Ofsted Rating: Requires improvement Pupils: 378 Distance:6.32	<input type="checkbox"/>	<input checked="" type="checkbox"/>	<input type="checkbox"/>	<input type="checkbox"/>	<input type="checkbox"/>
 Kenninghall Primary School Ofsted Rating: Good Pupils: 106 Distance:6.58	<input type="checkbox"/>	<input checked="" type="checkbox"/>	<input type="checkbox"/>	<input type="checkbox"/>	<input type="checkbox"/>

Local Area Masts & Pylons



Key:

-  Power Pylons
-  Communication Masts

What is Radon?

Radon is a natural radioactive gas, which enters buildings from the ground. Exposure to high concentrations increases the risk of lung cancer. The UK Health Security Agency (UKHSA) recommends that radon levels should be reduced in homes where the annual average is at or above 200 becquerels per cubic metre (200 Bq/m³).

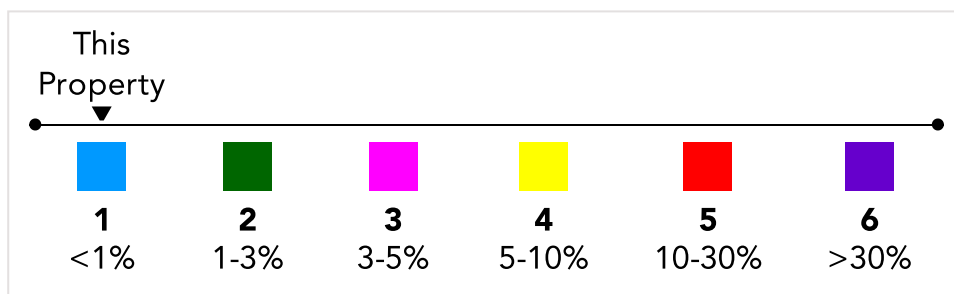
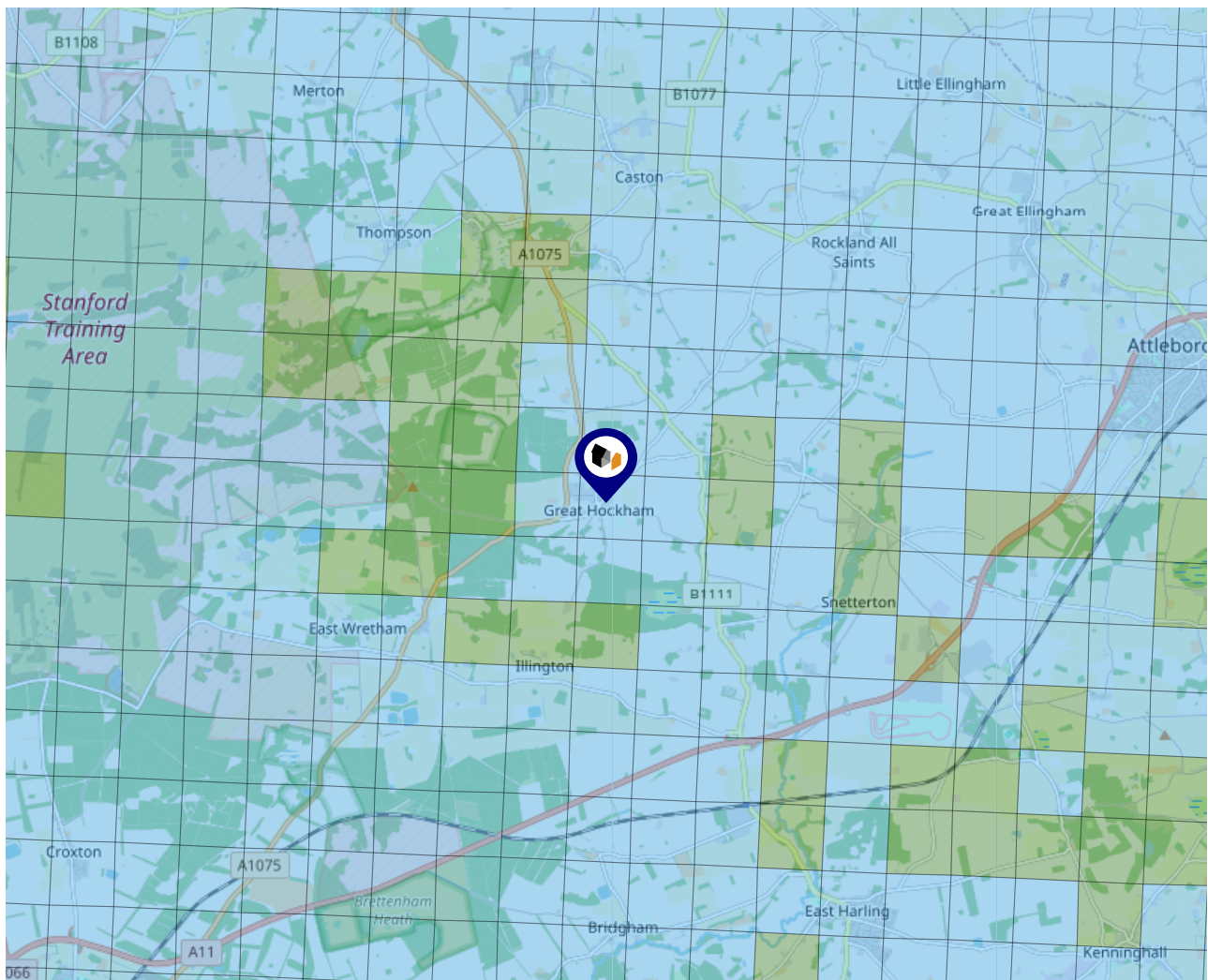

Local Area Road Noise

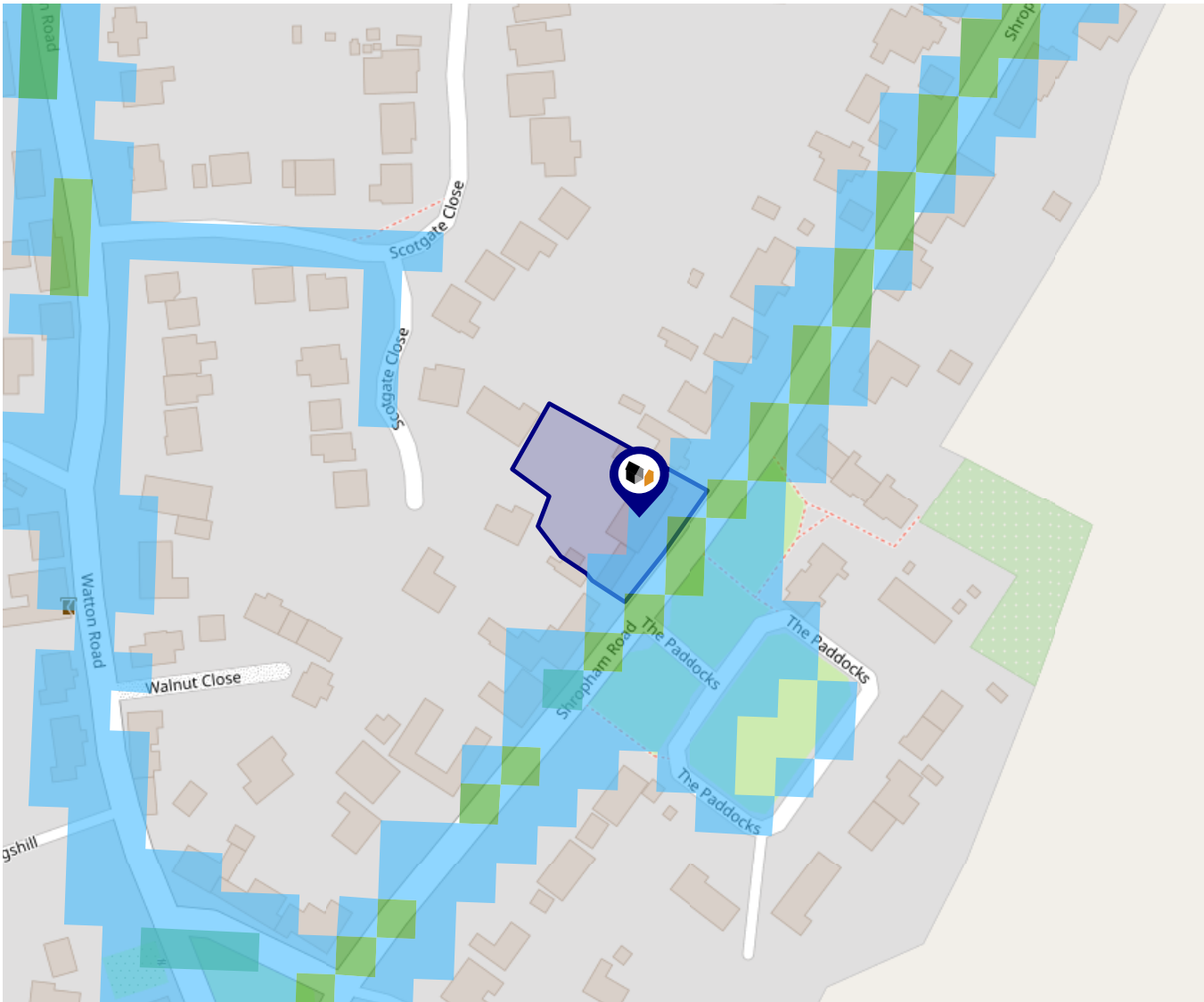

The data indicates the level of noise according to strategic noise sources across all traffic routes. This indicates a 25 house annual average noise level with separate weightings for the evening and the night periods.

- 75.0+ dB
- 70.0-74.9 dB
- 65.0-69.9 dB
- 60.0-64.9 dB
- 55.0-59.9 dB



Ground Composition for this Address (Surrounding square kilometer zone around property)

Carbon Content:	VARIABLE	Soil Texture:	LOAM TO CLAYEY LOAM, LOCALLY CHALKY
Parent Material Grain:	MIXED (ARGILLIC- RUDACEOUS)	Soil Depth:	DEEP
Soil Group:	MEDIUM TO LIGHT(SILTY) TO HEAVY		

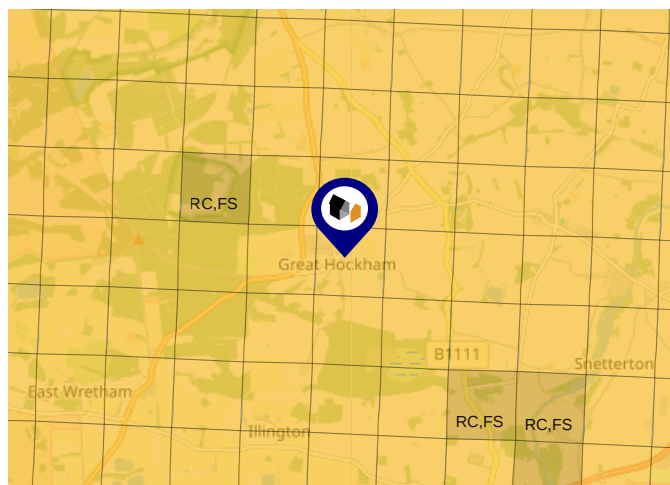

Primary Classifications (Most Common Clay Types)

C/M	Claystone / Mudstone
FPC,S	Floodplain Clay, Sand / Gravel
FC,S	Fluvial Clays & Silts
FC,S,G	Fluvial Clays, Silts, Sands & Gravel
PM/EC	Prequaternary Marine / Estuarine Clay / Silt
QM/EC	Quaternary Marine / Estuarine Clay / Silt
RC	Residual Clay
RC/LL	Residual Clay & Loamy Loess
RC,S	River Clay & Silt
RC,FS	Riverine Clay & Floodplain Sands and Gravel
RC,FL	Riverine Clay & Fluvial Sands and Gravel
TC	Terrace Clay
TC/LL	Terrace Clay & Loamy Loess

Area

Transport (National)

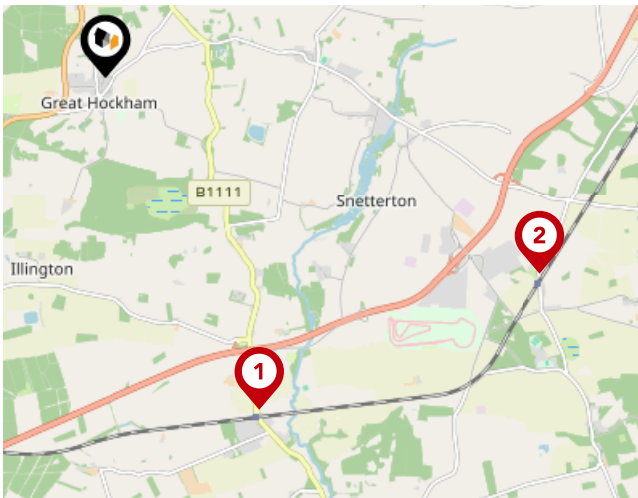

National Rail Stations

Pin	Name	Distance
1	Harling Road Rail Station	3.29 miles
2	Eccles Road Rail Station	4.29 miles
3	Attleborough Rail Station	6.22 miles

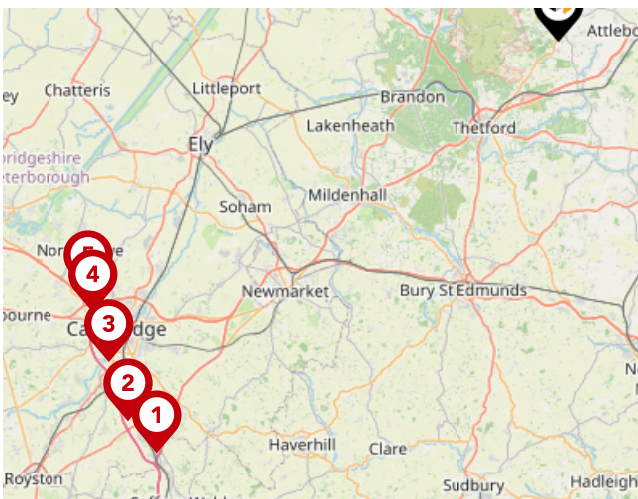

Trunk Roads/Motorways

Pin	Name	Distance
1	M11 J9	41.85 miles
2	M11 J10	41.68 miles
3	M11 J11	40.16 miles
4	M11 J13	39.1 miles
5	M11 J14	38.75 miles



Airports/HELIPADS

Pin	Name	Distance
1	Norwich International Airport	20.66 miles
2	Cambridge	35.86 miles
3	Stansted Airport	49.43 miles
4	Southend-on-Sea	64.62 miles

Area

Transport (Local)

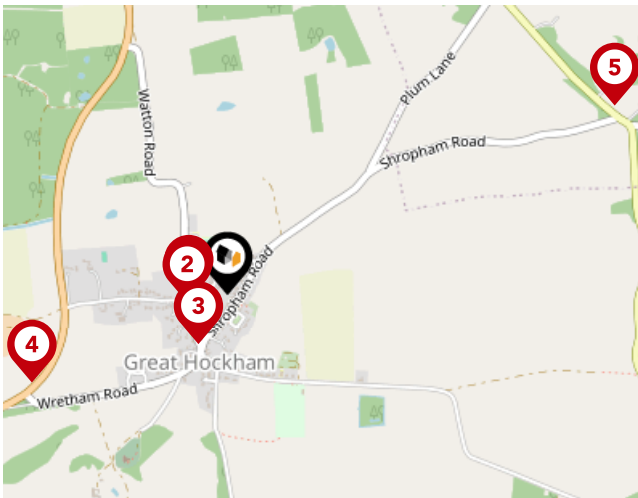

Bus Stops/Stations

Pin	Name	Distance
1	post office	0.09 miles
2	post office	0.09 miles
3	green	0.13 miles
4	turn	0.48 miles
5	Watton Road	0.97 miles

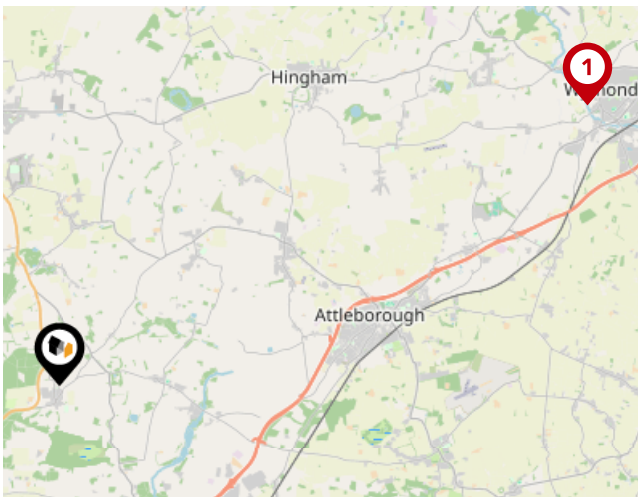

Local Connections

Pin	Name	Distance
1	Wymondham Abbey (Mid Norfolk Railway)	10.8 miles



Whittleby Parish | Attleborough

At Whittleby Parish, we strive to offer the best experience for all of our valued clients. We employ an experienced team and support our people with the best processes, cutting edge technology, marketing and training. We continue to improve and learn from feedback to strive to be the best at what we do and achieve.

Our proactive approach combined with advertising across four major property portals (Rightmove, Zoopla, onthemarket.com and Primelocation) as well as on social media platforms; coupled with our large database of registered applicants allows us to promote our properties to the widest target market.

With family roots still at the heart of all operations, Alex Parish ensures the original ethos and vision continues to run throughout the company's core, never comprising the personal service its reputation has been built upon.



Testimonial 1



It was a pleasure doing business with the Attleborough branch. Kept to every promise made and acted really fast. Made a stressful time far less stressful.

Testimonial 2



We asked Whittley Parish Diss to carry out a house valuation for us. Alex Parish came to do the job - he was kind, considerate and professional. The process was thorough but yet quick and easy for us. We couldn't ask for more - many thanks.

Testimonial 3



The whole team at Whittley Parish were first class from first introduction to final sale. With lots of estate agents in the Long Stratton area, this is the only one you need to know. Excellent would highly recommend.



[/whittleyparishmanagementltd](#)



[/whittleyparish](#)



[/whittleyparish/?hl=en](#)

Whittleby Parish | Attleborough

Data Quality

We are committed to comprehensive property data being made available upfront to make the home buying and selling process quicker, easier and cheaper. This is why we have partnered with Sprift, the UK's leading supplier of property-specific data.



Contains public sector information licensed under the Open Government License v3.0

The information contained within this report is for general information purposes only.

Sprift Technologies Ltd aggregate this data from a wide variety of sources and while we endeavour to keep the information up to date and correct, we make no representations or warranties of any kind, express or implied, about the completeness, accuracy, reliability, of the information or related graphics contained within this report for any purpose.

Any reliance you place on such information is therefore strictly at your own risk. In no event will we be liable for any loss or damage including without limitation, indirect or consequential loss or damage, or any loss or damage whatsoever arising from loss of data or profits arising out of, or in connection with, the use of this report.



Whittleby Parish | Attleborough

Suva House, Queens Square Attleborough

NR17 2AF

01953 711839

nick@whittlebyparish.com

www.whittlebyparish.com

