



38 Meadow Court, Littleport
Ely

RICHARD
BOOTH
ESTATE AGENTS 

£279,950

38 Meadow Court

Littleport, Ely

An extended detached house offered for sale with no upward chain.

Accommodation comprises entrance hall, spacious lounge, kitchen/dining room, utility, cloakroom, four bedrooms and bathroom whilst outside there is an excellent plot with lawned front and rear gardens, driveway and garage.

Council Tax Band: C

Tenure: Freehold

EPC Energy Efficiency Rating: D

- Extended Link Detached House
- 4 Bedrooms
- Spacious Lounge
- Kitchen/Dining Room & Utility
- Driveway, Garage & Good Sized Plot
- No Upward Chain







Entrance Hall

With door to front.

Lounge

With double glazed window to front, stairs to first floor, decorative fireplace, television point, radiator.

Kitchen/Dining Room

With double glazed window and French doors to rear, stainless steel sink and drainer, cooker space and extractor hood, wall and base level units, drawers and worksurfaces, gas boiler, radiator.

Utility

With double glazed window and door to rear garden, stainless steel sink unit and drainer, plumbing for washing machine, storage units and worksurfaces, door to garage, radiator.

Cloakroom

With low level WC, wash basin, radiator.

Landing

With access to loft, airing cupboard housing hot water cylinder.

Bedroom 1

With double glazed window to front, built in wardrobe, radiator.

Bedroom 2

With double glazed window to rear, built in cupboard, radiator.

Bedroom 3

With double glazed windows to front and rear, radiator.

Bedroom 4

With double glazed window to front, built in cupboard, radiator.

Bathroom

With suite comprising low level WC, wash basin, panelled bath with shower above, double glazed window to rear, radiator.



Outside

There are lawned gardens to the front and rear.

To the front there is a driveway leading to a single, integral garage with electricity connected.



Ground Floor

Main area: approx. 53.4 sq. metres (575.1 sq. feet)
Plus garages, approx. 13.2 sq. metres (142.0 sq. feet)

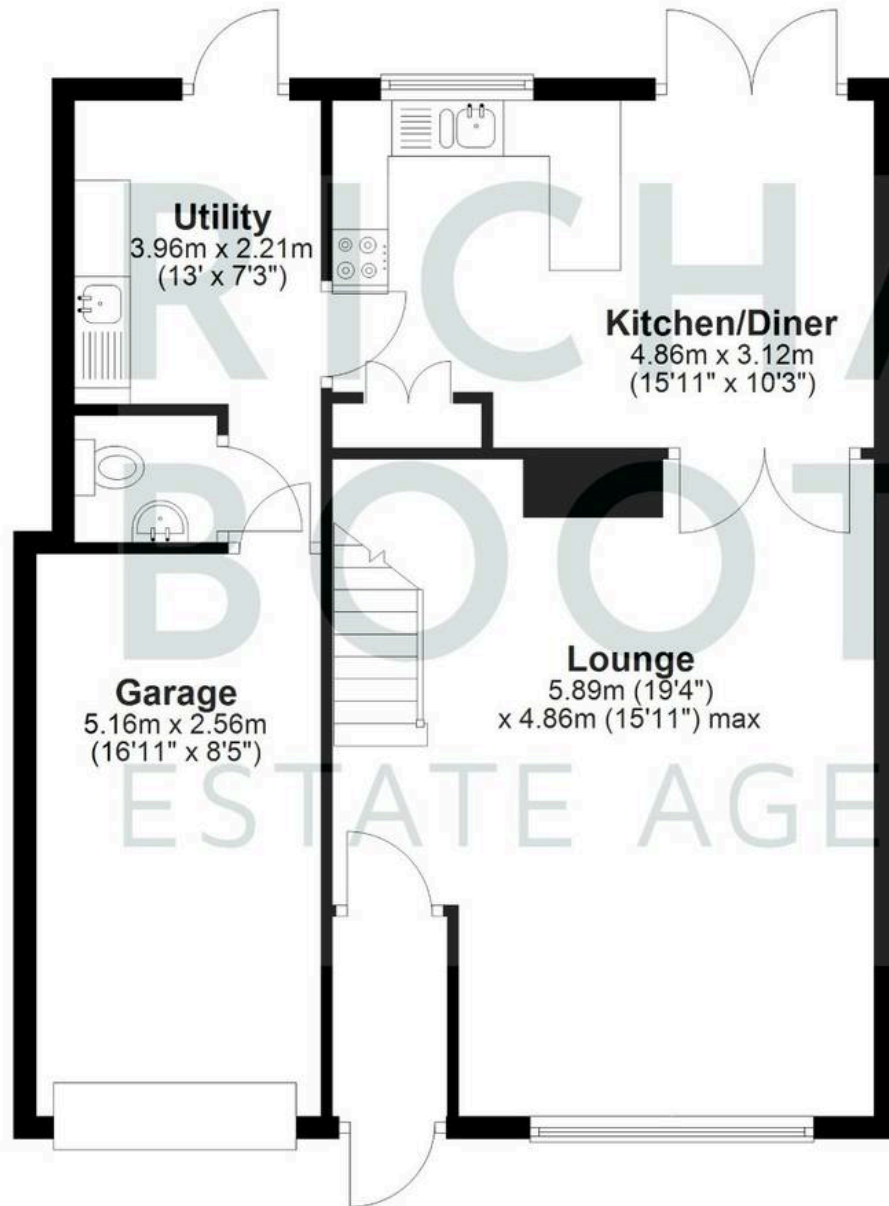

First Floor

Approx. 44.0 sq. metres (473.3 sq. feet)

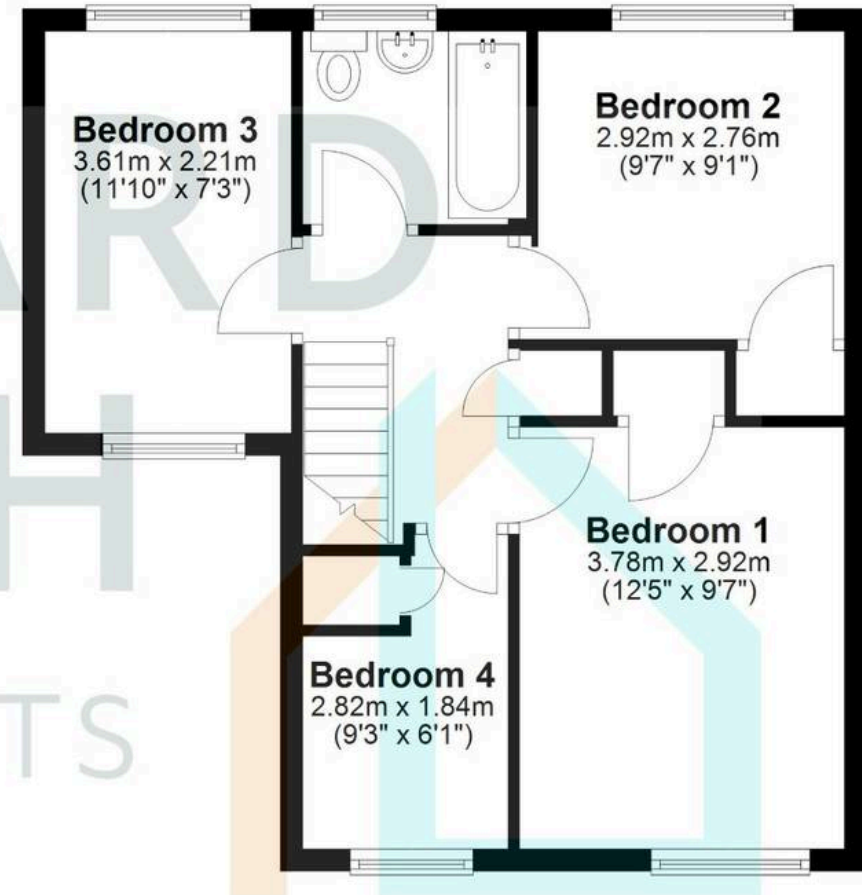

Main area: Approx. 97.4 sq. metres (1048.4 sq. feet)

Plus garages, approx. 13.2 sq. metres (142.0 sq. feet)



Richard Booth Estate Agents

Ely

01353 521267

info@richardbooth.org

richardbooth.org

These particulars are for guidance only and do not form part of any contract. Descriptions, measurements, and details are given in good faith but should not be relied upon as fact; buyers must verify accuracy themselves. No employee is authorised to make representations or warranties regarding this property. Measurements are approximate, and floor plans, photos, fixtures, and fittings are illustrative only.

