

SW19

it's all in the postcode...



Lake Road

£525,000

- Purpose built flat
- Three double bedrooms
- Near to Bishop Gilping school
- No onward chain
- Parking to the rear
- Council tax Band D
- EPC Rating



020 8544 2828

Wimbledon: Wimbledon Park: Colliers Wood

www.SW19.com

SW19 Estate Agents Ltd. Is registered in England & Wales No. 05508737

it's all in the postcode...

This spacious second-floor purpose-built apartment is ideally located just moments from Wimbledon town centre and positioned off Wimbledon Hill, providing excellent access to Wimbledon Station, with its National Rail, District Line and Tramlink services, as well as the area's extensive range of shops, restaurants and local amenities and close to Bishop Gilping school. Well presented throughout, the property offers three generous double bedrooms, a bright and spacious reception room, and access to attractive communal gardens. Further benefits include no onward chain. Well presented throughout, the property offers three generous double bedrooms, a bright and spacious reception room, and access to attractive communal gardens. Further benefits include no onward chain.



020 8544 2828
Wimbledon: Wimbledon Park: Colliers Wood
www.SW19.com
SW19 Estate Agents Ltd. Is registered in England & Wales No. 05508737

'it's all in the postcode...'

Lake Road SW19

Approx. Gross Internal Area 890 Sq Ft - 82.68 Sq M

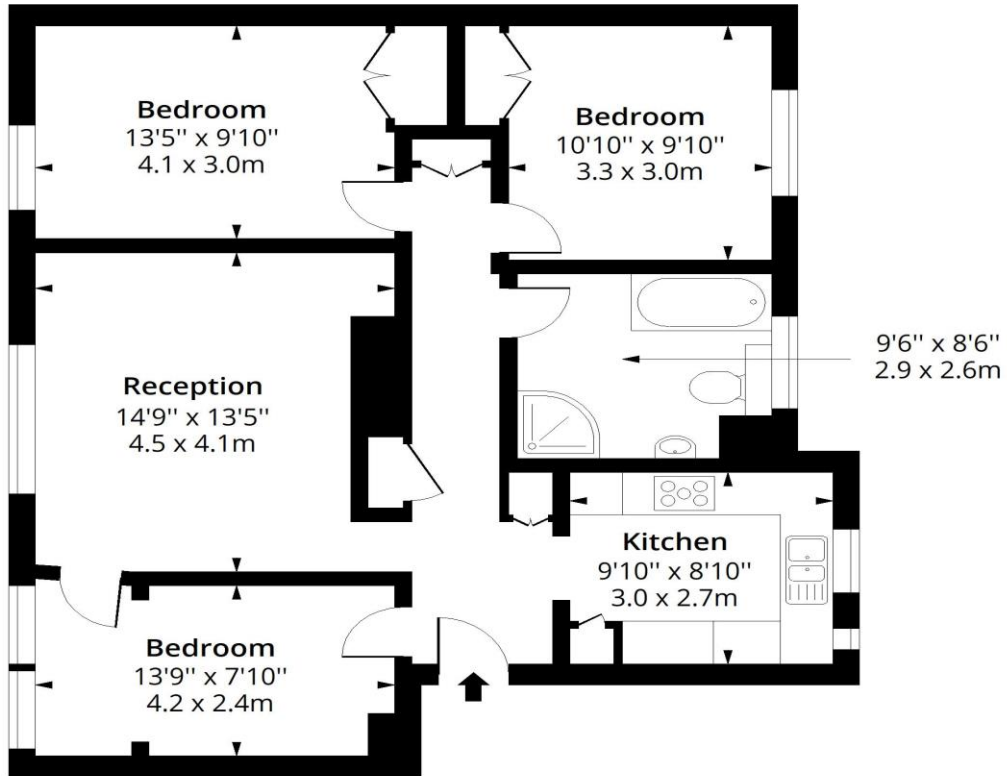
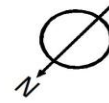

Second Floor

Floor Area 890 Sq Ft - 82.68 Sq M



Measured according to RICS IPMS2. Floor plan is for illustrative purposes only and is not to scale. Every attempt has been made to ensure the accuracy of the floor plan shown, however all measurements, fixtures, fittings and data shown are an approximate interpretation for illustrative purposes only. 1 sq m = 10.76 sq feet.

lpaplus.com

Date: 25/6/2026

These particulars are for guidance only and should not be relied upon as a statement or representation of fact. All measurements given are approximate only and should not be relied upon for ordering carpets, equipment etc. Purchasers should satisfy themselves by inspection or

020 8544 2828
Wimbledon: Wimbledon Park: Colliers Wood
www.SW19.com
SW19 Estate Agents Ltd. Is registered in England & Wales No. 05508737

'it's all in the postcode...'

otherwise as to the accuracy of the statements contained within. Neither SW19 estate agents ltd or related companies or their employees can confirm structural conditions of the property or that any appliances or other facilities are in working order. Purchasers are strongly recommended to arrange their own survey.

020 8544 2828

Wimbledon: Wimbledon Park: Colliers Wood

www.SW19.com

SW19 Estate Agents Ltd. Is registered in England & Wales No. 05508737

'it's all in the postcode...'