



PEMBERTON HOUSE, LONDON, EC4A 3AS

Asking Price £520,000

1 Bedrooms | 1 Bathrooms | To Let

Property Features

- One Bedroom
- Fitted Kitchen
- 4Th Floor
- Day Concierge
- No Chain
- Re Fitted Bathroom
- Carpeted Flooring
- Close to Fleet Street and Chancery Lane
- Security Entry System
- Walking Distance of Covent Garden

Situated just off FLEET STREET in a building called PEMBERTON HOUSE is this excellent size one bedroom apartment with re-fitted bathroom, this room now boasts limestone tiled flooring with under floor heating, heated towel rail and storage cupboards. The flat offers are very spacious rooms with a very good size bedroom with plenty of storage. The Kitchen is fully equipped with all modern appliance. Other great features of this fantastic flat are its location to Fleet Street and easy walk to Covent Garden.

Pemberton House is situated in a fantastic location close to Fleet Street and St Pauls (Central Line), Blackfriars (Circle Line) and the new Elizabeth Line Station at Farringdon. Within walking distance is Covent Garden. Also within easy reach are St. Pauls' Cathedral, The River, South Bank, Tate Modern, and the One New Change Shopping Complex with sixty shops, restaurants and bars.

Lease: 999 Years from 1998 Service Charge: £3488.00 per annum Ground Rent: £100 per annum
Council Tax Band G - £2215.93 per annum



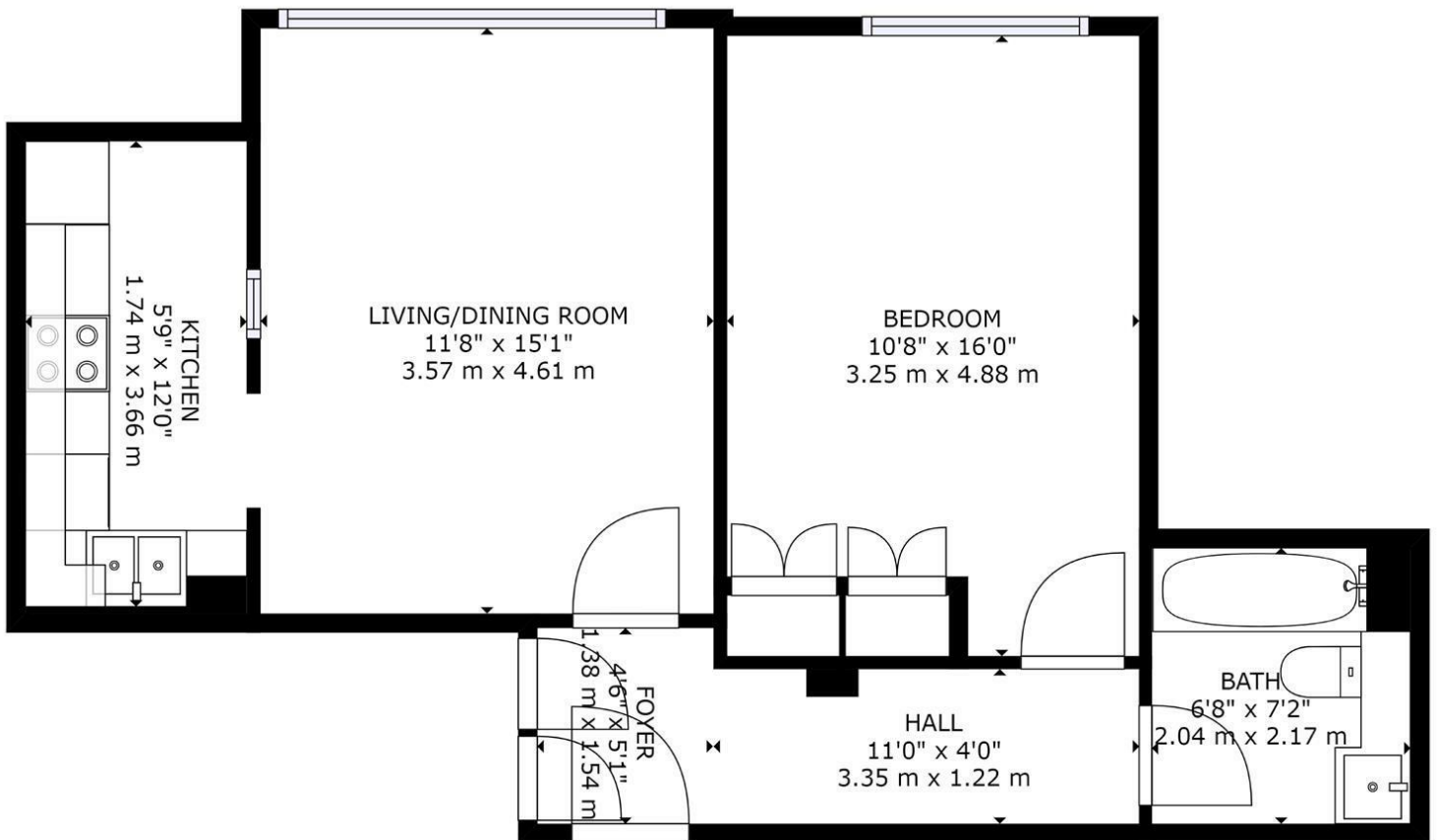

GROSS INTERNAL AREA
 550 sq ft, 51 m²
 TOTAL: 550 sq ft, 51 m²
 SIZES AND DIMENSIONS ARE APPROXIMATE, ACTUAL MAY VARY.

POWERED BY
matterport

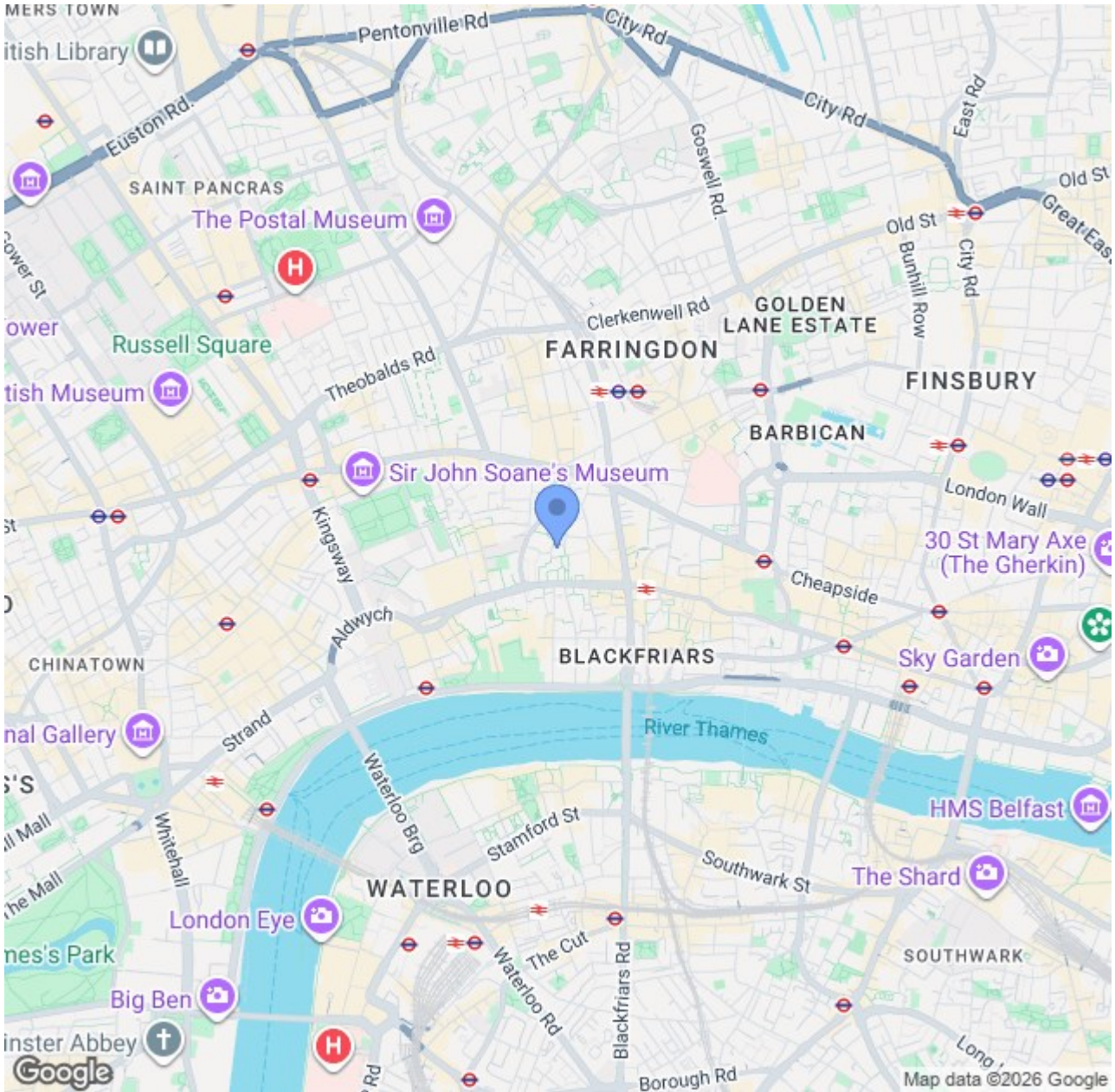

CONTACT US ABOUT THIS PROPERTY

122 Newgate Street, London, EC1A 7AA

T: 020 7600 0026

F: 020 7600 0025

E: property@scottcity.co.uk



Energy Efficiency Rating		Current	Potential
<i>Very energy efficient - lower running costs</i>			
(92 plus) A			
(81-91) B			
(69-80) C		77	78
(55-68) D			
(39-54) E			
(21-38) F			
(1-20) G			
<i>Not energy efficient - higher running costs</i>			
England & Wales		EU Directive 2002/91/EC	