

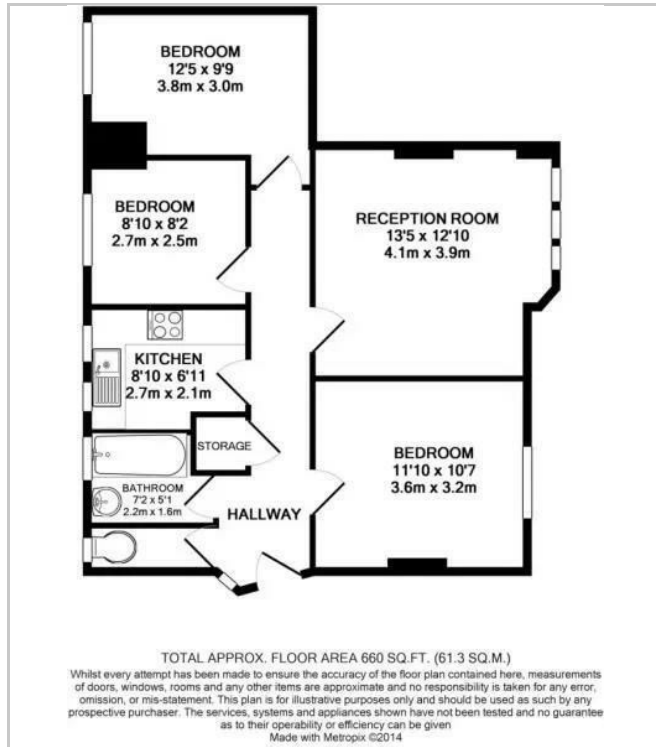

Tooting Grove, London, SW17 SW17
£2,500



Floor Plan



Accommodation

*** All enquiries or viewing requests should be submitted online via this advert - Thank you ***

Spacious three bedroom, recently refurbished apartment, ideally located within a few minutes walk of Tooting Broadway station. Situated on the 3rd and top floor in a well maintained block, the accommodation comprises of a good size living room, fitted kitchen with white good appliances and beautifully tiled shower suite. The property has gas central heating and double glazed windows.

Robertson House is located in a sought after location, within close proximity to Tooting Broadway, Tooting Bec and Balham Station. It is also situated on a quiet, residential road, which leads to the high street where you can find multiple shops, bars and restaurants.

- Price - rent £2500
- Deposit £2884.61
- Length of tenancy (12 months minimum)
- Council tax band - C
- EPC Rating - C



Area Map



Energy Efficiency Graph

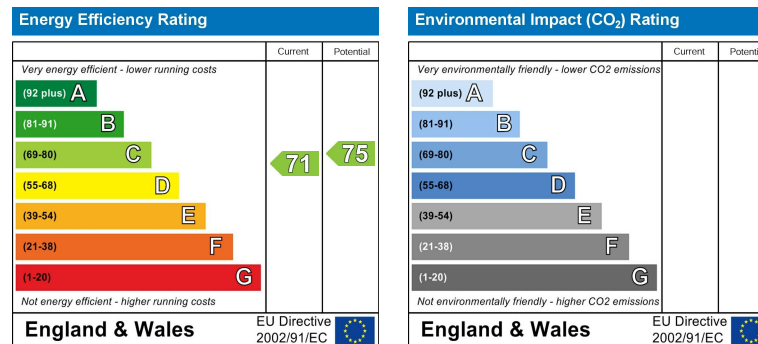

Please contact the HAUZOO office if you wish to arrange a viewing appointment for this property or require further information.
 HAUZOO, 3rd Floor 86-90 Paul Street, London, EC2A 4NE
 Tel: 02038784479 Email: enquiries@hauzoo.co.uk <https://www.hauzoo.co.uk>

These particulars, whilst believed to be accurate are set out as a general outline only for guidance and do not constitute any part of an offer or contract. Intending purchasers should not rely on them as statements of representation of fact, but must satisfy themselves by inspection or otherwise as to their accuracy. No person in this firm's employment has the authority to make or give any representation or warranty in respect of the property.