

Location:

Churchfield Road is centrally located close to the amenities of Acton and Shepherd's Bush. Both Acton Central and East Acton stations are close by for links to and from central London.

Key points:

- One Double bedroom apartment
- 467 sqft
- Acton Park is a short walk away
- Modernised throughout
- Offered to the market with no onward chain
- Situated on the popular Churchfield Road, W3
- 6 Minute walk to Acton Central Station

Do Better:

Acton
sales@astonrowe.co.uk

57-59 Churchfield Road,
Acton, London, W3 6AY

020 8992 3600

Aston Rowe



Churchfield Road
Approximate Gross Internal Area = 43.4 sq m / 467 sq ft

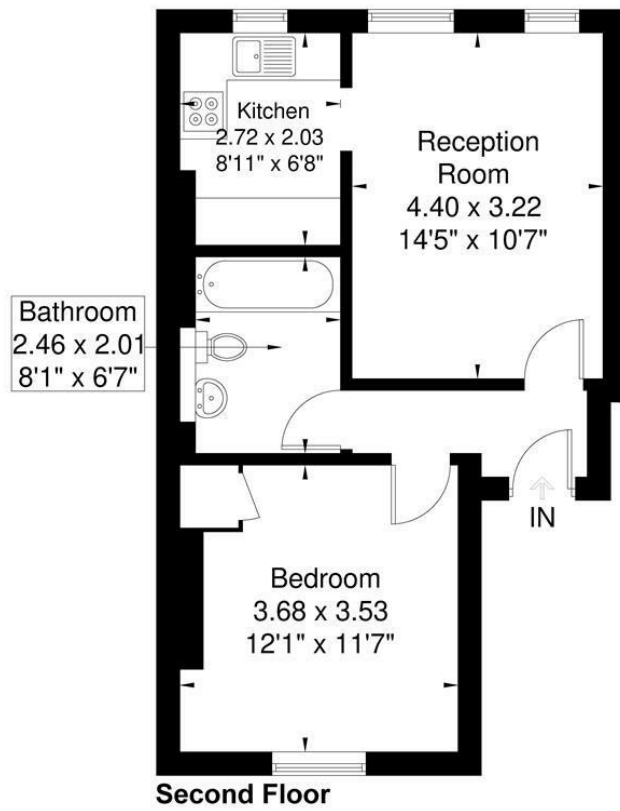

Although every attempt has been made to ensure accuracy, all measurements are approximate. The floorplan is for illustrative purposes only and not to scale.
© www.perspective.co.uk

Energy Efficiency Rating		Environmental Impact (CO ₂) Rating	
Current	Potential	Current	Potential
84	84		
68			

Offers In Excess Of £250,000

Churchfield Road, London W3 6BY

- 1 Reception Rooms
- 1 Bedrooms
- 1 Bathrooms



The current owner says:

The property is in a fantastic location for the local schools, parks, shops and transport links.

A beautifully presented modern one-bedroom apartment extending to over 457 sq ft, offered to the market with a long lease and no onward chain. Bright and inviting throughout, the property has been thoughtfully designed to provide comfortable and practical living accommodation.

The apartment benefits from attractive wooden flooring, enhancing the warmth and elegance of the living spaces. The spacious reception room offers an ideal setting for both relaxing and entertaining, while the separate kitchen provides practical space for everyday use.

The property further comprises a generous double bedroom filled with natural light and a contemporary tiled bathroom.

Ideally situated on Churchfield Road, the apartment enjoys an enviable position within one of Acton's most sought-after locations. Churchfield Road is renowned for its vibrant café culture and excellent selection of independent shops, bars, and restaurants, creating a lively and welcoming neighbourhood atmosphere.

Excellent transport links are available nearby, including Acton Central (London Overground) and Acton Main Line station, providing fast access to the Elizabeth line and convenient connections into Central London and beyond.

What's better:

A lovely one bedroom apartment in Acton

