

EUSTACE BUILDING, 372

QUEENSTOWN ROAD, SW11 8PP

£600 PER WEEK

Lavish one bedroom apartment located on the first floor in the Eustace Building at Chelsea Bridge Wharf. This beautifully furnished one bedroom has peaceful views overlooking the piazza water gardens that form the centrepiece of Chelsea Bridge Wharf, complete with a balcony and full length windows. Generous size bedroom with a separate sandstone bathroom. Good storage space throughout.

A stone's throw from Sloane square is the beautiful Chelsea Bridge Wharf development, located on the banks of the river Thames and Chelsea Bridge and adjacent to the wide-open spaces Battersea Park this iconic development enjoys a level of peace and tranquillity that is unrivalled in prime central London at its heart lies the award-winning water gardens that offer a tranquil oasis between the beautiful glass buildings that surround it. The Development boasts excellent views, 24-hour concierge, large terraces, comfort cooling and heating, as well as underground parking (not included), The apartments are a short walk to the new northern line extension connecting the complex to the city and west end within 5 stops.

- 518 sq ft
- 1st Floor
- One Bedroom, One Bathroom
- Open Plan Reception
- Balcony
- 24 Hour Concierge

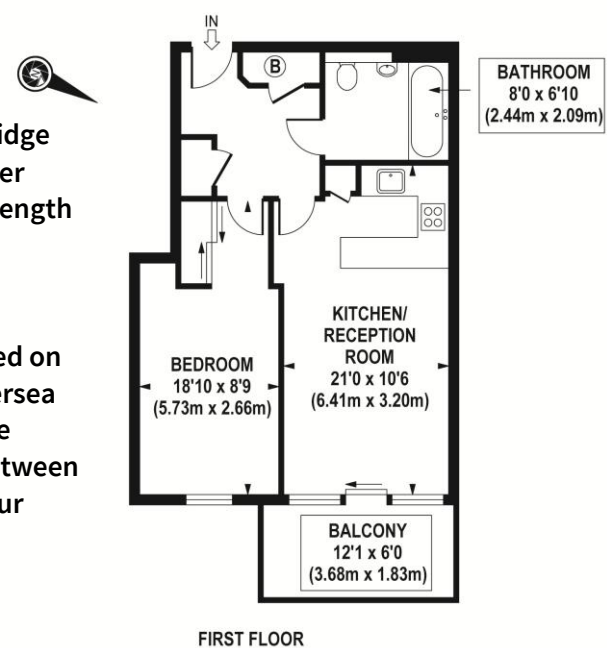

APPROX. GROSS INTERNAL AREA 518 sq.ft / 48.10 sq.m

