

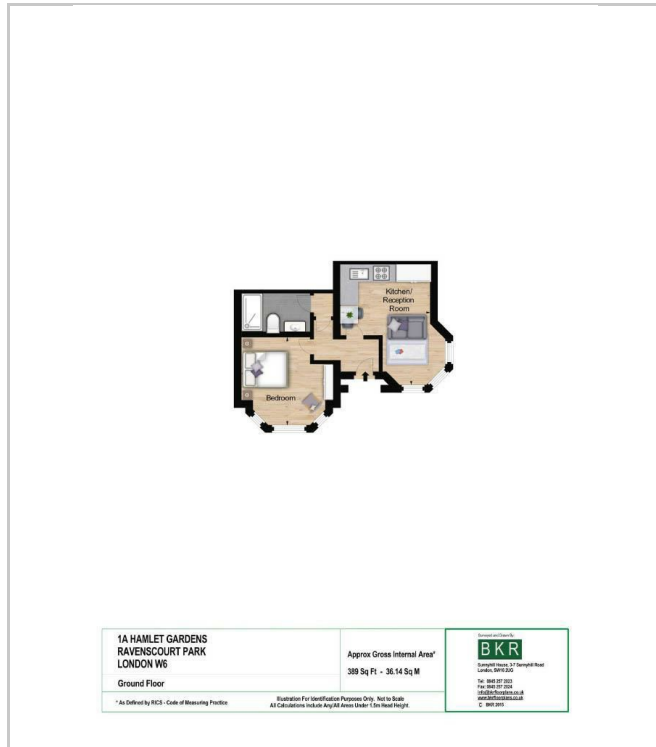

Hamley Gardens, London, W6 W6  
£540 Per week



## Floor Plan



## Accommodation

DML01650

A unique, bright one double bedroom apartment situated on the ground floor of a Victorian mansion block with its own private entrance.

The apartment has been interior designed to a very high specification and comprises a modern fully fitted open plan kitchen/diner, reception room and modern separate bathroom. Further features include two bay sash windows, video entry phone and hardwood flooring.

Local amenities of Chiswick High Road are a stone's throw away. Transport links: Stamford Brook and Ravenscourt Park tube stations (District line) located a 2 minute walk away.

EPC - D  
Council Tax - D



## Area Map



## Energy Efficiency Graph

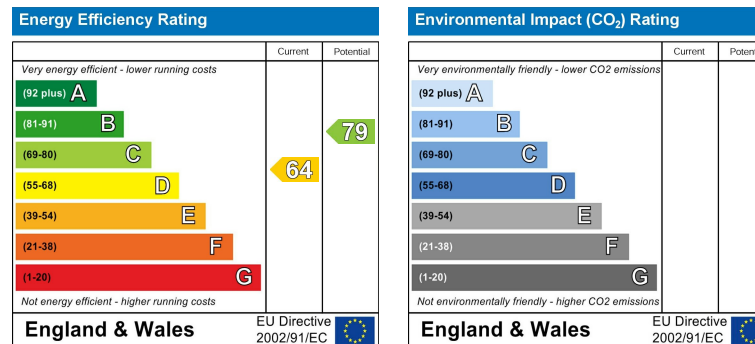

Please contact the Hauxoo office if you wish to arrange a viewing appointment for this property or require further information.  
Hauxoo, Suite 506 115 Coventry Road, London, E2 6GG  
Tel: 02038784479 Email: enquiries@hauxoo.co.uk www.hauxoo.co.uk

These particulars, whilst believed to be accurate are set out as a general outline only for guidance and do not constitute any part of an offer or contract. Intending purchasers should not rely on them as statements of representation of fact, but must satisfy themselves by inspection or otherwise as to their accuracy. No person in this firm's employment has the authority to make or give any representation or warranty in respect of the property.