



Finches

Gardenside, Charmouth, Dorset

Finches

Gardenside

Charmouth

Dorset DT6 6BA

Detached two bedroom bungalow with potential to create two further bedrooms with wonderful sea views across Lyme Bay.



- Coastal sea views
- Driveway parking for multiple vehicles
- Walking distance to village, beach, shops and pubs
- Modernisation required
- Huge potential



Guide Price **£450,000**

Freehold

Bridport Sales
01308 422092
bridport@symondsandsampson.co.uk



INTRODUCTION

Finches lies in a private road above Charmouth Village affording it some wonderful views across Lyme Bay and the surrounding countryside yet is within walking distance of the beach, a number of good shops and public houses. The property is now in need of updating and refurbishment with potential to create two further bedrooms and a bathroom in the roof space subject to obtaining the necessary planning consents as similar neighbouring properties have done. This really is an opportunity.

ACCOMMODATION

The accommodation is simply laid out with the living room taking the best of the views through sliding doors to the front with the focal point of a fireplace equipped with a woodburning stove opposite. Double doors flow through to a bedroom that could be used as a second reception room and also has the sea views through a large picture window. Behind the hallway there is a fully fitted kitchen, a second bedroom and a bathroom. Also on the ground floor, off the kitchen, there is a back hall and a doorway through to an integral garage.

There is a non compliant staircase to the centre of the house that rises up to the first floor which has a large room with a window offering a view at either end and could easily

be divided into two bedrooms once a compliant staircase has been put in place. The property has UPVC double glazing and gas fire central heating.

OUTSIDE

To the front of the property, the gardens are laid for the most part to lawn with a lovely Apple tree to one side and a number of mature shrubs to the edges. There is parking for a number of cars on a tarmac drive to one side that leads up to the double length garage equipped with an up and over door, light and power. To the rear of the property there is an enclosed garden that at the moment is a blank canvas and enclosed by a combination of timber fencing and stone wall.

SITUATION

The property is close to the beach in the charming seaside village of Charmouth, which has a number of good shops, public houses and restaurants to its centre as well as a primary school, pharmacy and sports facilities. It lies midway between the former rope-making town of Bridport to the east and the Devon carpet making town of Axminster to the west. The A35 provides the major road link while there are mainline stations at Dorchester and Axminster. Sporting, walking and riding opportunities abound within the area while the world Heritage site

Jurassic coastline stretches all the way along Lyme Bay with Charmouth itself being well known for its fossil finds.

DIRECTIONS

What3words:///expect.travel.trombone

SERVICES

Mains water, electricity and drainage. Gas central heating. Broadband - Superfast speed available. Mobile - There is mobile coverage in the area, please refer to Ofcom's website for more details. EPC: D

LOCAL AUTHORITY

Dorset Council - 01305 251010
Tax Band: D

AGENTS NOTE

Gardenside Close is a private road that is maintained at the expense of all the properties that lie along it.



Energy Efficiency Rating		Current	Potential
Very energy efficient (lowest carbon value)			
A	79-100		
B	69-78		
C	59-68		
D	49-58		
E	39-48		
F	29-38		
G	1-28		
Minimum energy efficient rating value			
England & Wales		EU Directive	2002/91/EC

Finches, Gardenside, Charmouth, Bridport

Approximate Area = 1238 sq ft / 115 sq m
 Garage = 191 sq ft / 17.7 sq m
 Total = 1429 sq ft / 132.7 sq m
 For identification only - Not to scale

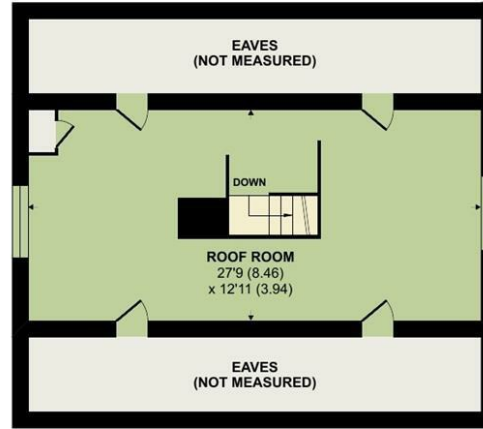

Floor plan produced in accordance with RICS Property Measurement 2nd Edition, Incorporating International Property Measurement Standards (IPMS2 Residential). © nichecom 2026. Produced for Symonds & Sampson. REF: 1467577



Bridport/DME/03062026



01308 422092

bridport@symondsandsampson.co.uk
 Symonds & Sampson LLP
 23, South Street,
 Bridport, Dorset DT6 3NU



Important Notice: Symonds & Sampson LLP and their clients give notice that they have no authority to make or give any representations or warranties regarding the property. These particulars do not form part of any offer or contract and must not be relied upon as statements of fact. Some descriptions and images may have been AI-assisted; while reviewed for accuracy, interested parties should verify key details through inspection or by contacting our agents. All measurements and distances are approximate. Text, photographs, and plans are for guidance only and may not be comprehensive. It should not be assumed that the property has all necessary planning or regulatory consents, and no services, equipment, or facilities have been tested. No investigations have been made into pollution or contamination; purchasers must make their own enquiries. The property is sold subject to all existing wayleaves, easements, and rights of way (public or private), whether mentioned or not. Vendors are not required to define such rights.