



Fyfield Road, Enfield EN1 3TT

PCM £1,700 PCM

Flat - Conversion |

Council: Enfield | Council Tax Band: C



Peter Barry
working harder for you



Peter Barry are pleased to present this beautifully appointed first-floor Edwardian conversion, offering two well-proportioned bedrooms and set in the vibrant heart of Enfield Town.

This charming property showcases a spacious lounge enhanced by an elegant feature fireplace, alongside a generous kitchen complete with quality appliances. A fully tiled bathroom adds a sleek, modern touch, while beautiful hardwood flooring extends seamlessly throughout, lending warmth and character to every room. Additional benefits include gas central heating, double-glazed windows, and a valuable loft space for storage.

Perfectly positioned, the flat enjoys superb transport connections, placing Central London within easy reach, and is moments from a variety of excellent local shops, cafés, and amenities. Just 0.2 Miles away from Enfield Town Train Station. (Direct to London Liverpool Street in 30 mins)

This property is ideally suited to small families and busy commuters seeking style, comfort, and convenience in equal measure.

Contact our lettings team today to secure your viewing.

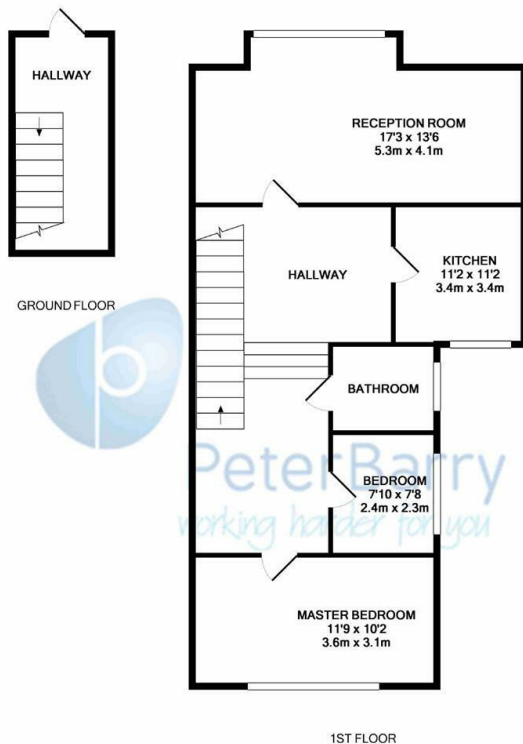

Whilst every attempt has been made to ensure the accuracy of the floor plan contained here, measurements of doors, windows, rooms and any other items are approximate and no responsibility is taken for any error, omission, or mis-statement. This plan is for illustrative purposes only and should be used as such by any prospective purchaser. The services, systems and appliances shown have not been tested and no guarantee as to their operability or efficiency can be given.
Made with Metropix ©2017



| Energy Efficiency Rating | | |
|---|-------------------------|-----------|
| | Current | Potential |
| Very energy efficient - lower running costs | | |
| (92 plus) A | | |
| (81-91) B | | |
| (69-80) C | | |
| (55-68) D | 67 | 70 |
| (39-54) E | | |
| (21-38) F | | |
| (1-20) G | | |
| Not energy efficient - higher running costs | | |
| England & Wales | EU Directive 2002/91/EC | |

How to Make an Offer

To submit an offer, please email theo.stylianou@pbea.co.uk with the following details (We reserve the right to request further info if required by law).

Offer Amount (£) – Confirm the amount you wish to offer.

Buyer Type – Confirm whether you are purchasing in your personal name/s or through a company and provide full details

Mortgage Agreement – Provide your Agreement in Principle or Mortgage Offer. If you need a mortgage broker, we can recommend one at no charge.

Deposit Confirmation – Submit the last three months' bank statements showing the full deposit amount, whether in one or multiple accounts. We reserve the right to request further in if required.

Identification – Include your full name as listed on a valid photographic ID (passport, driving license, or other official document).

Proof of Address – Supply a document verifying your current address.

Solicitor Details – Provide your solicitor's full details, including name, firm address, direct contact number, and email. If you need a solicitor, we can recommend one at no charge.

Mortgage Broker Details – Submit your mortgage broker's full details, including name, firm address, direct contact number, and email. If you need a mortgage broker, we can recommend one at no charge.

AML & Identity Checks – Confirm when Lifetime Legal can contact you to process a £75.00 payment and complete electronic identity and Anti-Money Laundering (AML) checks.

What Are ID & Anti Money Laundering Checks

We are required by law to conduct anti-money laundering checks on all those selling or buying a property. Whilst we retain responsibility for ensuring checks and any ongoing monitoring are carried out correctly, the initial checks are carried out on our behalf by Lifetime Legal who will contact you once you have agreed to instruct us in your sale or had an offer accepted on a property you wish to buy. The cost of these checks is £75 (incl. VAT), which covers the cost of obtaining relevant data and any manual checks and monitoring which might be required. This fee will need to be paid by you in advance of us publishing your property (in the case of a vendor) or issuing a memorandum of sale (in the case of a buyer), directly to Lifetime Legal, and is non-refundable. We will receive some of the fee taken by Lifetime Legal to compensate for its role in the provision of these checks.

Proof of Funds

An estate agent may ask for proof of funds at two different stages and for two different reasons. If an estate agent asks for proof of funds before you put an offer in, it may be because they want to make sure you have a genuine interest in the property to avoid any disappointment for the seller. However, you don't have to provide proof of funds before putting an offer in.

Source of Funds (SOF)

(SOF) is the process of verifying the origin of a customer's money for a specific transaction. The goal is to ensure that the funds are not from illegal activities.

Evidence of Property Sale:

If you intend to use proceeds from an ongoing property sale, you will be required to provide supporting documentation. Acceptable evidence includes a letter from your solicitor, confirmation from your broker, a detailed breakdown of the funds being allocated, and an Agreement in Principle (AIP) covering the remaining balance. Additionally, please provide either written confirmation of the agreed sale price from your estate agent or a copy of the completion statement.