



St. Albans Avenue, London, W4 5JT

Guide Price £350,000

WHITMAN & CO.

SALES · LETTINGS · COMMERCIAL

- Second floor
- Bathroom
- 16'2 reception room

- Two double bedrooms
- Popular residential road
- Kitchen

Tenure - Leasehold
 Lease Length - 175 years
 Ground Rent - peppercorn
 Service Charge - £2,113.27 pa
 Local Authority - Ealing
 Council Tax - Band D

THE PROPERTY

A top floor purpose-built two bedroom flat, ideally located on this sought after residential road, a short walk from Chiswick High Road and close to Southfield Park. The flat needs updating, with the accommodation comprising a 16'2 reception room, two double bedrooms, a kitchen, a bathroom, extensive storage both within the flat and in a further external storage cupboard, and private and communal garden areas. Ideally located on this tree-lined residential road within a short walk of Chiswick High Road's shops, cafes and restaurants. Transport links include Turnham Green and Chiswick Park stations, local bus routes and the A4/M4 for routes in and out of London.

St Albans Avenue, W4

Approximate gross internal area

61.38 sq m / 661 sq ft

(Including Private Store Room)

Private Store Room : 1.68 sq m / 18 sq ft

Key :
 CH - Ceiling Height

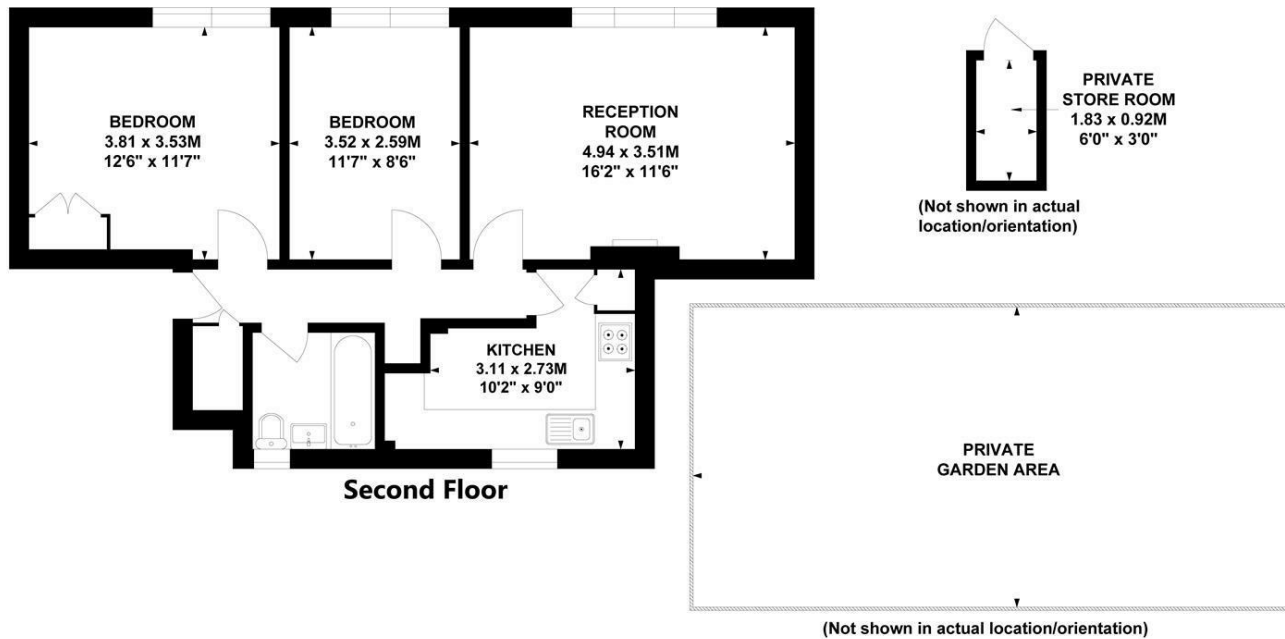

Not to scale, for guidance only and must not be relied upon as a statement of fact.
 All measurements and areas are approximate only

SITUATION

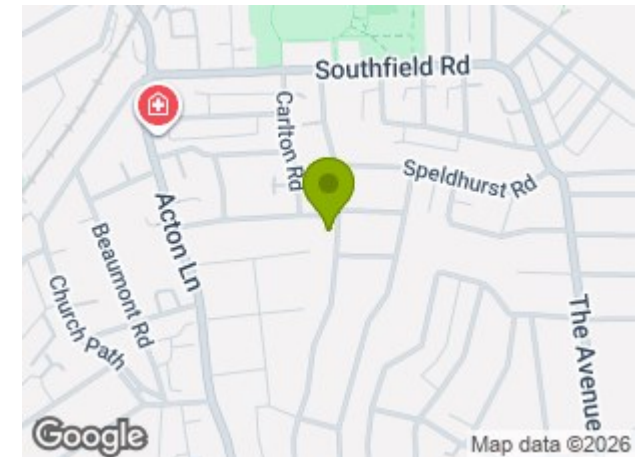

5-7 Turnham Green Terrace, Chiswick, London, W4 1RG

Tel 020 8747 8800

E-mail sales@whitmanandco.com

Website www.whitmanandco.com



MISREPRESENTATION ACT 1967

Whitman & Co. for themselves and for the vendors give notice that these particulars do not constitute any part of, an offer of contract. All statements contained in these particulars are made without responsibility on the part of Whitman & Co. or the vendor. None of the statements contained in these particulars is to be relied upon as statements or representations of facts. Any intending purchaser must satisfy himself by inspection or otherwise as to the correctness of each of the statements contained in these particulars. The vendor does not make or give, and neither Whitman & Co. or any person in their employment has any authority to make or give, any representation or warranty whatever in relation to the property.