



2 5 Hamilton Park, London, N5 1SH

£2,800 Per Month

2 5 Hamilton Park, London N5 1SH

A stunning two bedroom flat set within an elegant Victorian Conversation on Hamilton Park.

This beautifully presented property comprises two double bedrooms, a spacious reception room with an adjoining kitchen, a well appointed bathroom and the added benefit of a front garden area.

Perfectly positioned in the heart of Highbury, the property is just moments from the independent shops, cafes and restaurants of Highbury Barn and Highbury Village. The open green spaces of Highbury Fields are on your doorstep, while excellent bus links and Highbury & Islington Station are within easy walking distance, providing superb transport connections across London.

Offered unfurnished and available from 31st July 2026.



Council Tax Band: D

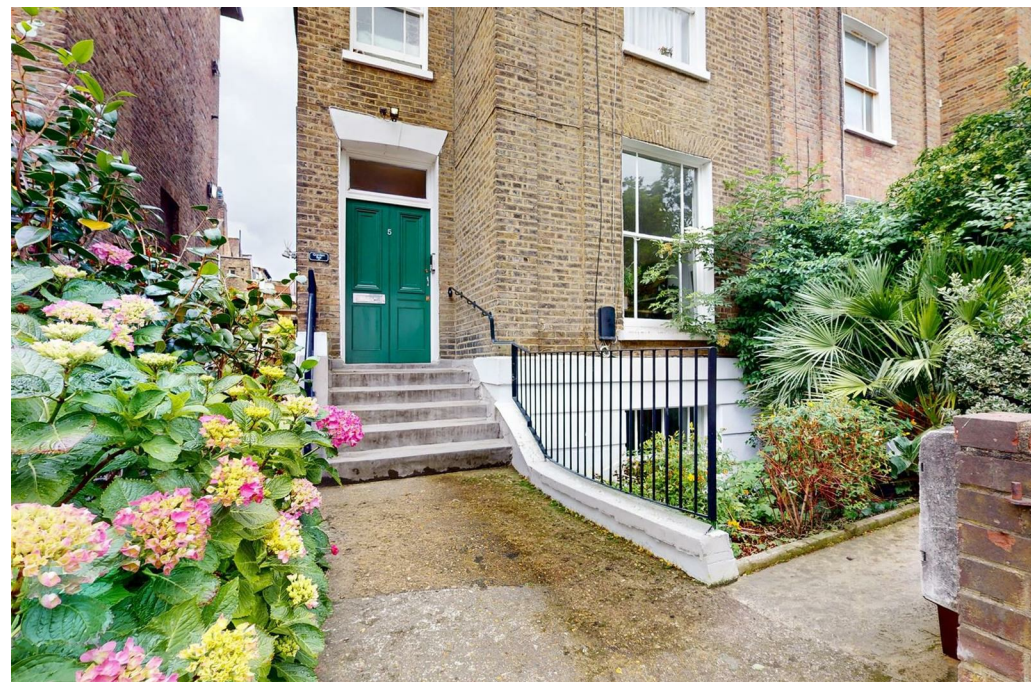

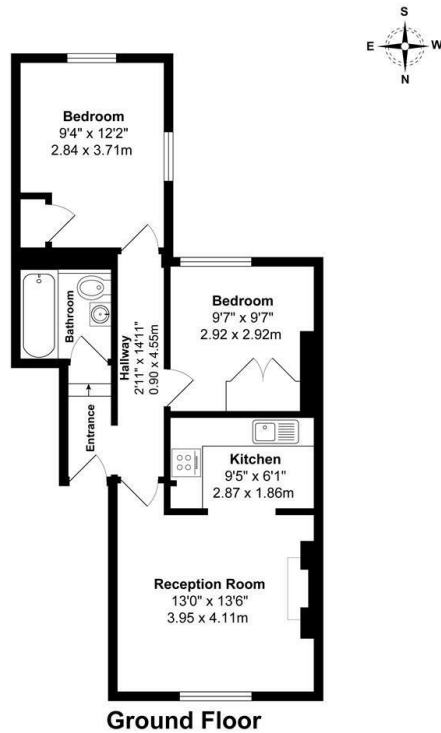

Ground Floor
 Hamilton Park, N5
 Total Gross Internal Area = 553 ft² / 51.4 m²
 Floor plans are for identification and guideline purpose only not to scale
 Compliant RICS code of measuring practice

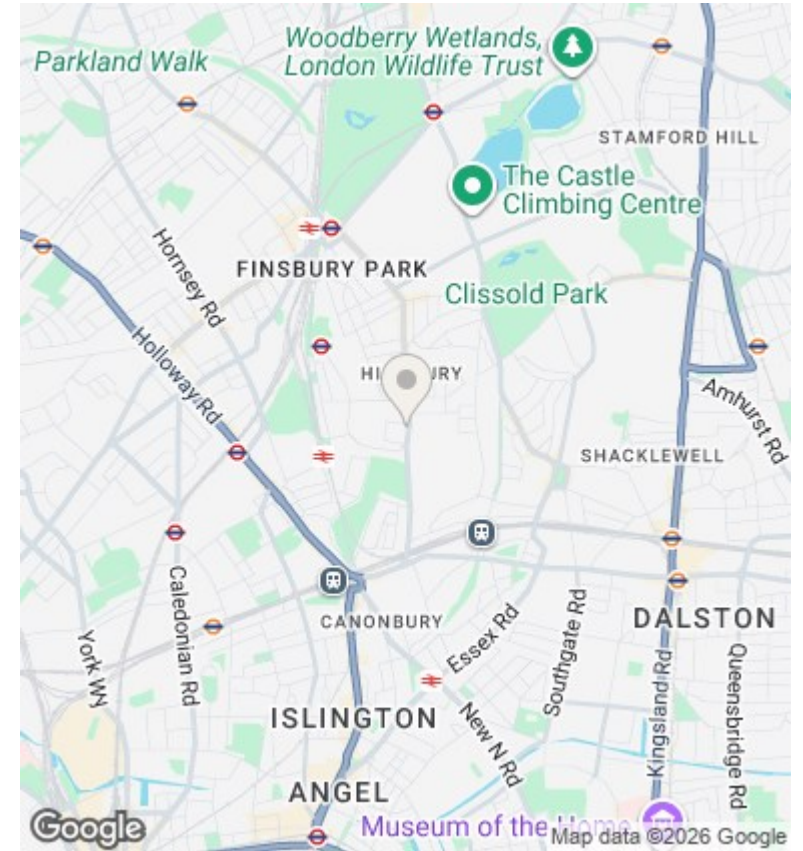

Directions

Viewings

Viewings by arrangement only. Call 02073593191 to make an appointment.

Council Tax Band

D

Energy Efficiency Rating		Current	Potential
Very energy efficient - lower running costs			
(92 plus) A			
(81-91) B			
(69-80) C			78
(55-68) D	67		
(39-54) E			
(21-38) F			
(1-20) G			
Not energy efficient - higher running costs			
England & Wales	EU Directive 2002/91/EC		



