

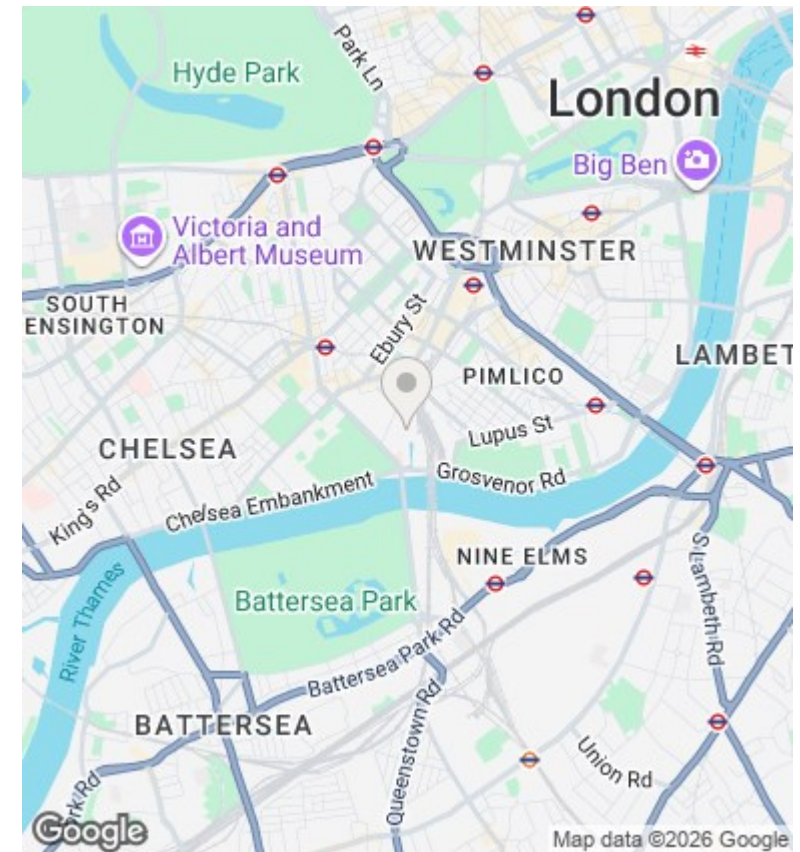

Caro Point, Gatliff Road, Grosvenor Waterside, Sloane Square SW1W 8BD

£1,200 Per Week

- 24/7 concierge
- underground parking
- private balcony
- minutes away from Battersea Park
- gym and spa
- air cooling
- on site nursery Purple Dragon
- west facing
- under floor heating
- minutes away from Sloane Square and Victoria stations

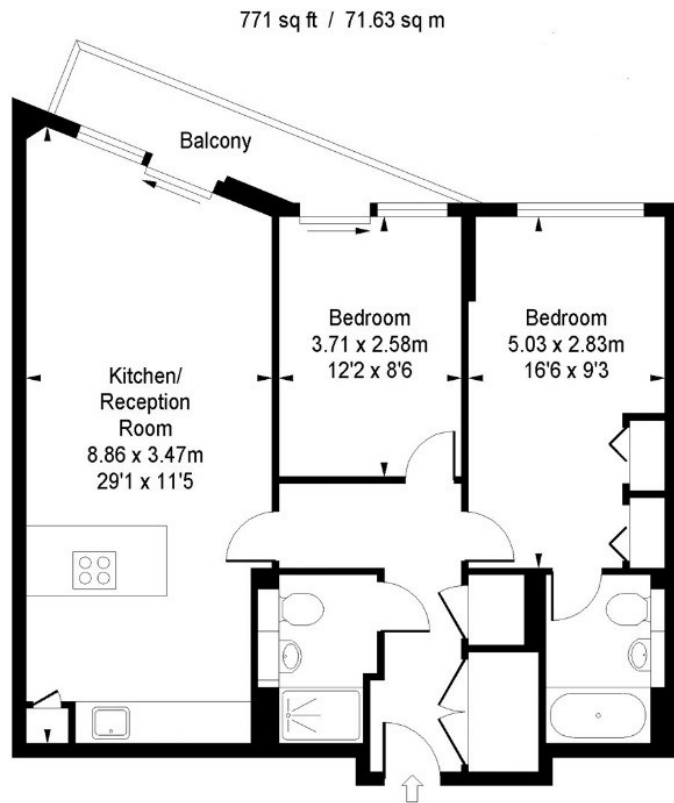

Viewings

Viewings by arrangement only.
Call 02077225022 to make an appointment.

Council Tax Band

F

EPC Rating:

Energy Efficiency Rating		Current	Potential
<i>Very energy efficient - lower running costs</i>			
(92 plus) A			
(81-91) B			
(69-80) C			
(55-68) D			
(39-54) E			
(21-38) F			
(1-20) G			
<i>Not energy efficient - higher running costs</i>			
England & Wales		EU Directive 2002/91/EC	