



Flat 15, The Strand, West Allington, Bridport, Dorset DT6 5BL

Second floor apartment located in the wonderful town of Bridport with amenities close by.



- Short walk to local town
- Two bedrooms
- Second floor apartment
- Covered off road parking

Guide Price **£160,000**

Leasehold

THE PROPERTY

A well-presented second floor apartment offering comfortable and practical accommodation, enhanced by an abundance of natural light.

The property benefits from a pleasant living area together with a fitted kitchen located just off it. There is a family bathroom as well as two bedrooms, the principle of which is a comfortable double.

A particular feature of the apartment is the inclusion of side windows, an unusual and desirable benefit within this block, helping to create a brighter and more open feel throughout.

OUTSIDE

The development benefits from lift access to all floors, providing ease and convenience for residents and visitors alike. Under cover allocated parking.

SITUATION

Bridport has a twice weekly market as well as regular farmers' markets and offers a range of quirky and artisan local shops as well as a vintage quarter. The town's

amenities include restaurants and hotels, a cinema and leisure centre, supermarkets, a museum, a health centre and a number of excellent primary schools and secondary schooling. Bridport has good access to the famous Jurassic Coast from the pretty harbour of West Bay with its assortment of pubs and restaurants and picturesque coastal path.

DIRECTIONS

What3words:///unlocking.sapping.crate

SERVICES

Mains water, electricity and drainage. Gas central heating
Broadband - Ultrafast speed available.
Mobile - There is mobile coverage in the area, please refer to Ofcom's website for more details.
EPC: C

LOCAL AUTHORITY

Dorset Council - 01305 251010
Tax Band: B

MATERIAL INFORMATION

Service charge £1188 pa. Ground rent £125 pa.

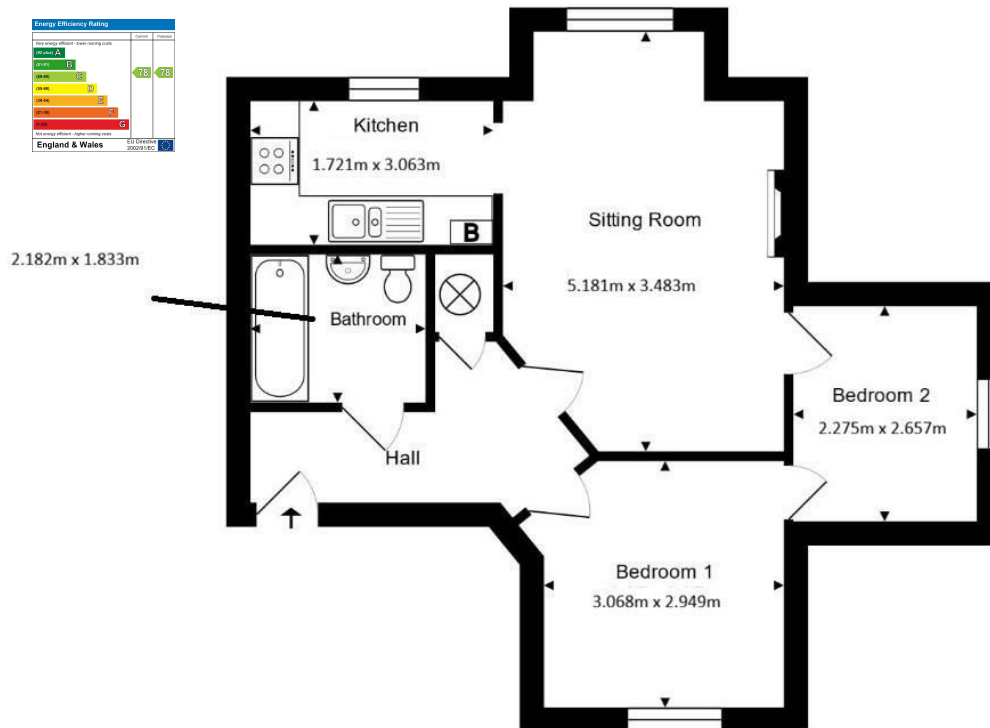

BRI/DM/REV16062026



01308 422092

bridport@symondsandsampson.co.uk
Symonds & Sampson LLP
23, South Street,
Bridport, Dorset DT6 3NU



Important Notice: Symonds & Sampson LLP and their Clients give notice that: 1. They have no authority to make or give any representations or warranties in relation to the property. These particulars do not form part of any offer or contract and must not be relied upon as statements or representations of fact. 2. Any areas, measurements or distances are approximate. The text, photographs and plans are for guidance only and are not necessarily comprehensive. It should not be assumed that the properties have all necessary planning, building regulation or other consents and Symonds and Sampson LLP have not tested any services, equipment of facilities. 3. We have not made any investigation into the existence or otherwise of any issues concerning pollution of the land, air or water contamination and the purchaser is responsible for making his/her own enquiries in this regard. 4. The property is sold subject to and with the benefit of all existing wayleaves, easements and rights of way whether public or private, specifically mentioned or not. The vendors shall not be required to define any such rights, privileges or advantages.