

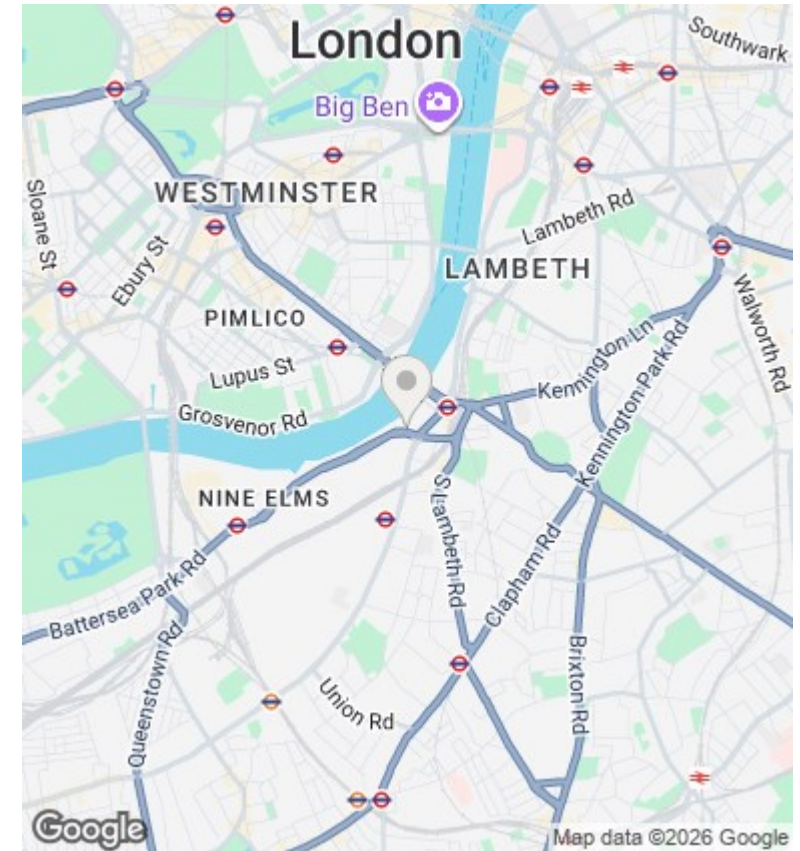

The Tower, St. George Wharf, Vauxhall, London SW8 2DU

£1,750,000

- 24/7 CONCIERGE
- UNDER GROUND PARKING
- GATED DEVELOPMENT
- GYM / SPA WITH SWIMMING POOL OVERLOOKING RIVER
- VIDEO VIEWING AVAILABLE
- REFURBISHED WITH FULL RIVER VIEWS
- CINEMA
- 3 BEDROOM 2 BEDROOM
- SMART HOME SYSTEM
- RESIDENCE LOUNGE WITH MEETING ROOM / DINNING ROOM

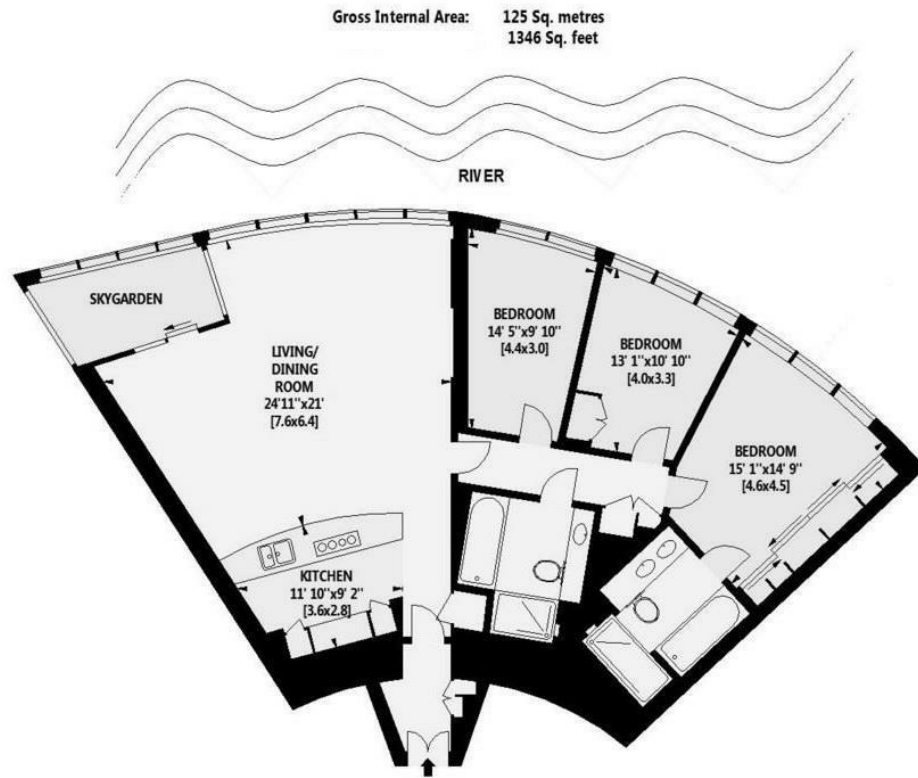

Viewings

Viewings by arrangement only.
Call 02077225022 to make an appointment.

Council Tax Band

B

EPC Rating:

B

| Energy Efficiency Rating | | Current | Potential |
|--|--|-------------------------|-----------|
| <i>Very energy efficient - lower running costs</i> | | | |
| (92 plus) A | | | |
| (81-91) B | | 85 | 85 |
| (69-80) C | | | |
| (55-68) D | | | |
| (39-54) E | | | |
| (21-38) F | | | |
| (1-20) G | | | |
| <i>Not energy efficient - higher running costs</i> | | | |
| England & Wales | | EU Directive 2002/91/EC | |