

C. JAMES & CO.

SALES AND LETTINGS AGENTS



Flat 21, Vantage House 1 Weir Road

, Wimbledon, SW19 8UX

£1,350 PCM



Flat 21, Vantage House 1 Weir Road



Description

C James & Co are pleased to offer this well-presented and Spacious Studio apartment located within the Vantage House development on Weir Road, SW19.

The apartment benefits from a modern fitted kitchen with integrated appliances, good storage throughout, and a contemporary bathroom finished to a high standard.

Residents benefit from an on-site concierge service together with an allocated parking space, all within a well-maintained modern development.

Ideally positioned for access to Wimbledon town centre, the property is within easy reach of a wide range of shops, cafés, restaurants and leisure facilities. Haydens Road Thameslink station and Wimbledon station are both nearby, providing excellent transport links into Central London and surrounding areas.

EPC Rating C
Merton Council Tax Band C

- Studio
- residents parking
- 1st Floor
- high ceilings



Floor Plan

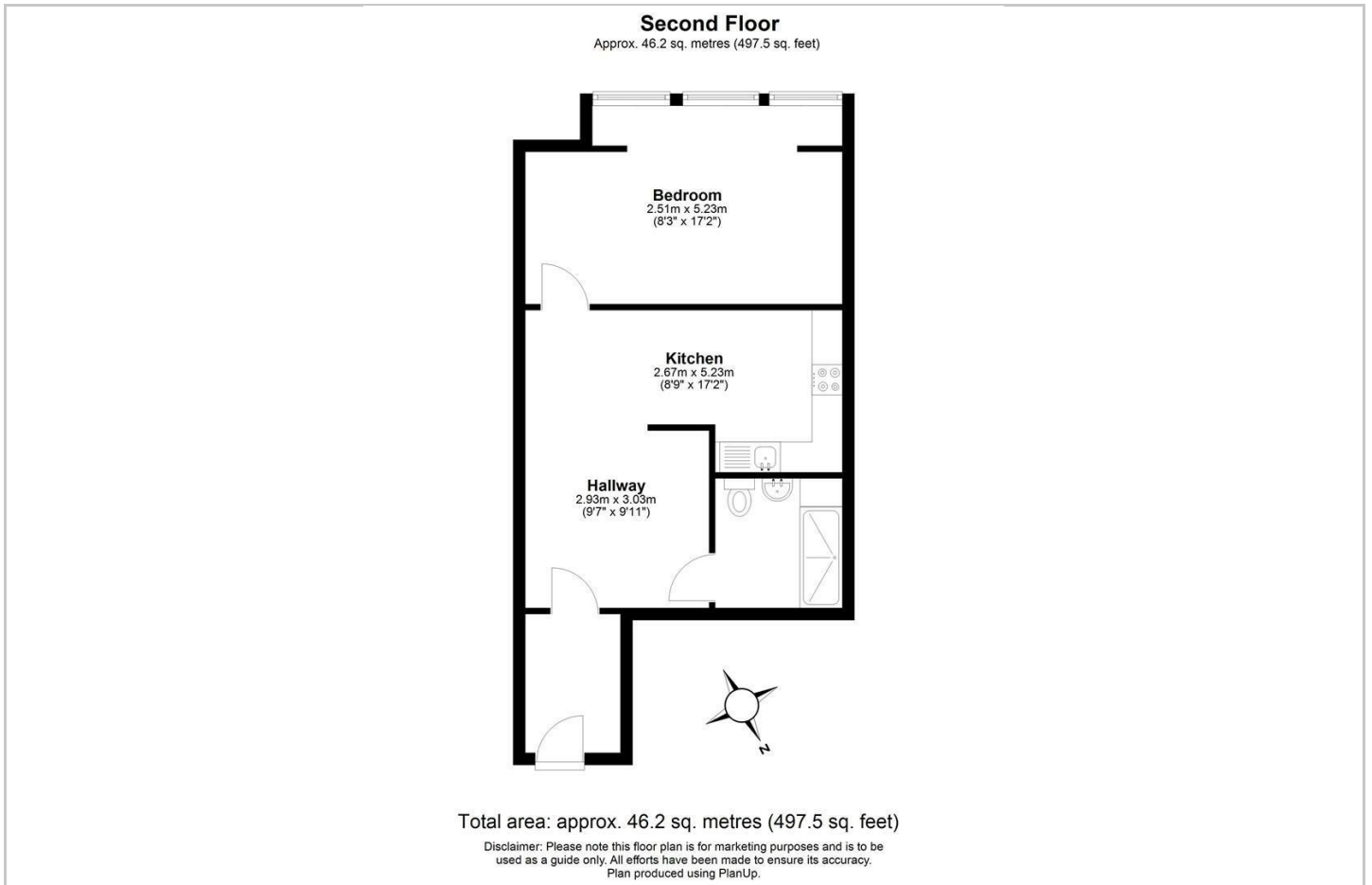

Area Map

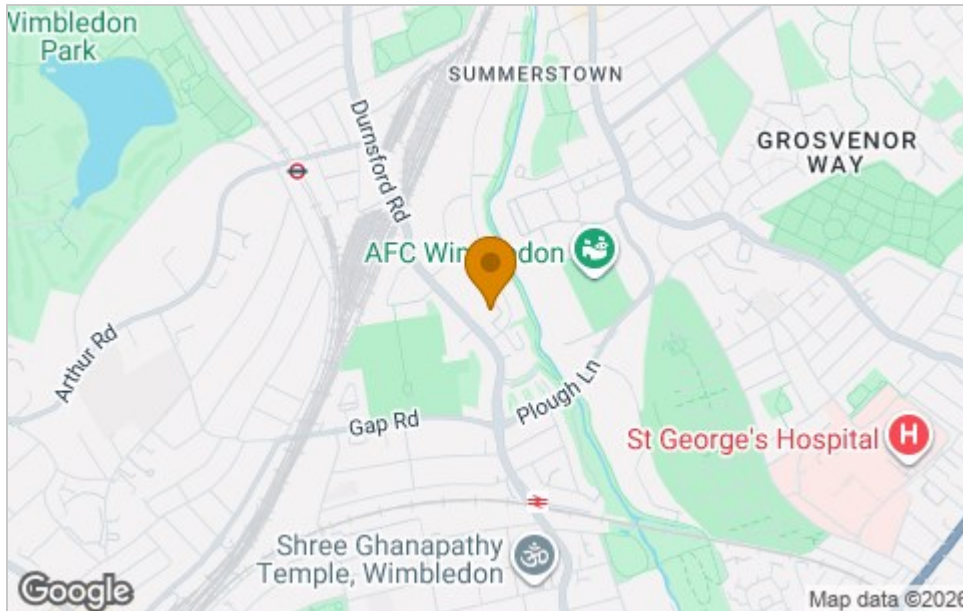

Energy Efficiency Graph

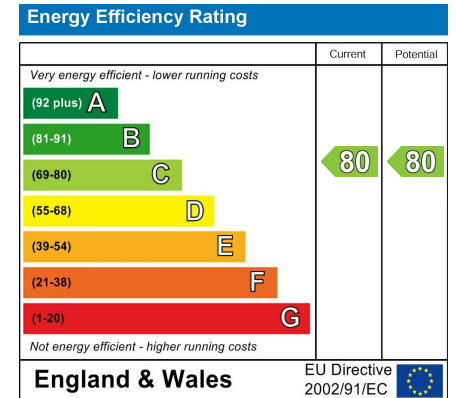

Viewing

Please contact our C James & Co Office on 0208 542 3232 if you wish to arrange a viewing appointment for this property or require further information.

These particulars, whilst believed to be accurate are set out as a general outline only for guidance and do not constitute any part of an offer or contract. Intending purchasers should not rely on them as statements of representation of fact, but must satisfy themselves by inspection or otherwise as to their accuracy. No person in this firm's employment has the authority to make or give any representation or warranty in respect of the property.