

Location:

Ideally positioned in the heart of Ealing, this attractive property enjoys a highly sought-after location just 0.2 miles from Ealing Broadway Station, providing exceptional connectivity via the Elizabeth Line, Central Line and District Line. Residents benefit from immediate access to the vibrant array of shops,

Key points:

- Two Double Bedrooms
- First Floor
- Seconds From Ealing Broadway
- Period Conversion
- EPC - C
- No Chain
- Multiple Transport Links Within 5 minute Walk
- Long Lease 145 yrs

Do Better:

Acton
sales@astonrowe.co.uk

57-59 Churchfield Road,
Acton, London, W3 6AY

020 8992 3600



Windsor Road
Approximate Gross Internal Area = 59.2 sq m / 637 sq ft

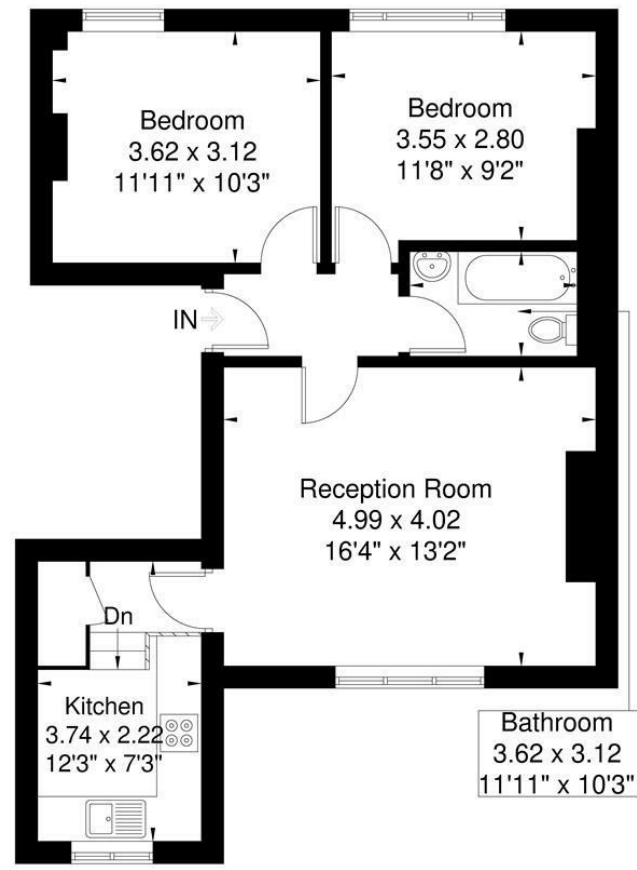

First Floor

Although every attempt has been made to ensure accuracy, all measurements are approximate. The floorplan is for illustrative purposes only and not to scale.
© www.perspective.co.uk

Energy Efficiency Rating		Environmental Impact (CO ₂) Rating	
Current	Potential	Current	Potential
	79		

Energy Efficiency Rating: A (92+), B (81-91), C (69-80), D (55-68), E (39-54), F (21-38), G (1-20). Current: 69, Potential: 79.

Environmental Impact (CO₂) Rating: A (92+), B (81-91), C (69-80), D (55-68), E (39-54), F (21-38), G (1-20). Current: 69, Potential: 79.

England & Wales EU Directive 2002/91/EC

£470,000

Windsor Road, Ealing W5 5PD

- 1 Reception Rooms
- 2 Bedrooms
- 1 Bathrooms



The current owner says:

We loved the area and location from the moment we moved in. Being just a short stroll from the heart of Ealing Broadway meant we had fantastic shops, cafés and restaurants on our doorstep, while the nearby parks provided a wonderful escape and a real sense of community. The excellent transport links were one of the main reasons we bought the property, making it incredibly easy to travel across London and beyond.

Situated just moments from Ealing Broadway Centre, this attractive two-bedroom first-floor flat forms part of a charming period conversion. The property offers two spacious double bedrooms, a separate kitchen, and a bright and airy reception room measuring 16'4" x 12'2", enhanced by high ceilings and an abundance of natural light.

Presented in good condition throughout, the flat further benefits from a long lease, low service charges, and no onward chain, making it an excellent opportunity for both owner-occupiers and investors.

Windsor road is ideally positioned in the heart of Ealing, this attractive property enjoys a highly sought-after location just 0.2 miles from Ealing Broadway Station, providing exceptional connectivity via the Elizabeth Line, Central Line and District Line. Residents benefit from immediate access to the vibrant array of shops, restaurants, cafés and leisure facilities along Ealing Broadway, making it one of West London's most desirable destinations.

The property is also perfectly placed for enjoying the area's renowned green open spaces, with Ealing Common situated approximately 0.3 miles away and the beautiful Walpole Park within 0.5 miles. Offering an excellent balance of urban convenience and outdoor recreation, this location is particularly popular with professionals, families and commuters alike.

What's better:

Situated just moments from Ealing Broadway Centre, this attractive two-bedroom first-floor flat forms part of a charming period conversion. The property offers two spacious double bedrooms, a separate kitchen, and a bright and airy reception room measuring 16'4" x 12'2", enhanced by high ceilings and an abundance of natural light. Presented in good condition throughout, the flat further benefits from a long lease, low service charges, and no onward chain, making it an excellent opportunity for both owner-occupiers and investors.

