



Flat

271, EVERSOLT STREET, NW1 1BA

Per Calendar
£4,200

Available: 11th September 2026

FEATURES

- Large Three Bedroom Flat
- Double Height Ceilings
- Modern Bathroom
- Newly Refurbished
- Open Plan Living Room
- Large Windows
- Moments from Mornington Crescent Station
- Furnished



Huddletons

3 Bedroom Flat located in London

Welcome to Eversholt Street, NW1 - a vibrant location in the heart of the city! This stunning property boasts a spacious three-bedroom flat with one bathroom, perfect for those seeking a comfortable and modern living space.

Situated on the top floor of a charming period building, this flat offers a unique charm with double height ceilings that create a bright and airy atmosphere throughout. The property features a generous 886 sq ft of living space, providing ample room for relaxation and entertainment.

Conveniently located near Mornington Crescent Station, commuting is a breeze, making this an ideal home for busy professionals or families. The modern bathroom adds a touch of luxury to the property, ensuring both style and comfort are met.

Don't miss the opportunity to make this beautiful flat your new home. Contact us today to arrange a viewing and experience the elegance and convenience this property has to offer!

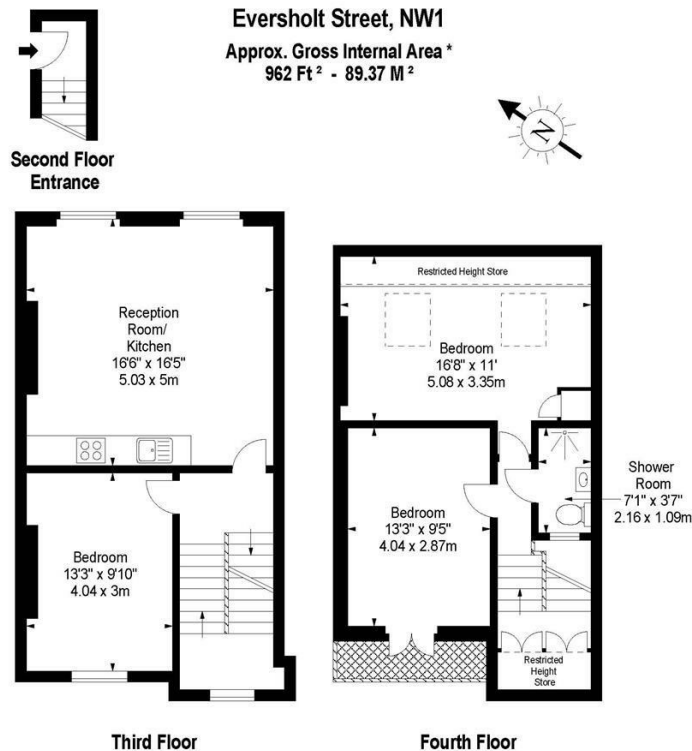

Every attempt has been made to ensure the accuracy of this floor plan however, measurements are approximate and for illustration purposes only. Measured in accordance with the RICS code of measuring practice. Not to scale

Call us on

0207 205 4411

info@huddletons.com

<http://www.huddletons.com>

Council Tax Band

C

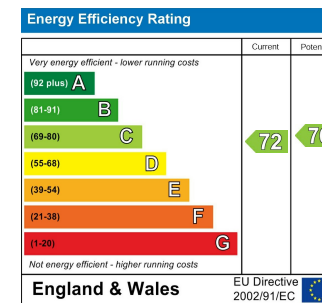

Agents Note: Whilst every care has been taken to prepare these particulars, they are for guidance purposes only. All measurements are approximate and are for general guidance purposes only and whilst every care has been taken to ensure their accuracy, they should not be relied upon and potential buyers are advised to recheck the measurements.

Huddletons